

Memorial Park Master Plan Update

Wilsonville Parks and Recreation Department
MAY 2015



ACKNOWLEDGMENTS

Wilsonville Parks and Recreation Department

Stan Sherer, Director
Tod Blankenship, Parks Supervisor
Brian Stevenson, Recreation Coordinator

City of Wilsonville

Kerry Rappold, Natural Resources Program Manager
Kurt Budlong, Analyst

Walker Macy

Mike Zilis, Principal in Charge
Ian Holzworth, Project Manager
Thomas Fischer, Landscape Designer

Conservation Technix, Inc.

Steve Duh, Principal

Pacific Habitat Services

John van Staveren, President

Architectural Cost Consultants, LLC

Stan Pszczolkowski, Estimator



Wilsonville
Parks and Rec

29600 SW Park Place
Wilsonville, OR. 97070
www.WilsonvilleParksandRec.com

WALKER | MACY

TABLE OF CONTENTS

I. Executive Summary

II. Introduction

- Park History
- Master Plan Approach
- Sustainable Development and Care

III. Public Involvement

- Community Involvement
- Stakeholders
- Public Open Houses
- Online Survey

IV. Site Analysis

- Context
- Regulations
- Circulation
- Vegetation
- Considerations
- Amenities
- Field Use

V. Initial Concepts

VI. Preferred Option

- Environment
- Park Areas:
 - Murase Plaza
 - West
 - Riverfront
 - East
- Circulation and Access
- Trails
- Priorities
 - Revenue and Operations
 - Costs
 - Phasing

VII. Appendix

- Meeting Summary Notes
- Stakeholder Summary Notes
- Survey Summary
- Revenue / Operations Proforma
- Estimate of Probable Cost

PAGE LEFT INTENTIONALLY BLANK



I. EXECUTIVE SUMMARY

EXECUTIVE SUMMARY

Located in the heart of Wilsonville, Oregon Memorial Park has been a significant community resource for its citizens for decades. Often referred to as Wilsonville's jewel, the 126 acre Regional Park is bordered by Wilsonville Road, Memorial Drive and the Willamette River. Generations of residents have enjoyed the wide variety of active, passive, programed and non-programed recreational experiences the park has to offer. The park also provides distinctive natural resources including its riparian forest along the Willamette River and Boeckman Creek, open meadows and forested hillsides. These resources play an important role in shaping the park's character and providing important wildlife corridors.

Community involvement was integral to the planning process. This included a City wide survey, stakeholder meetings, website communications and a three part series of public open houses that provided neighbors and citizens an active role in planning for the parks future. Critical to the community was balancing passive and active uses with protection and enhancement of the parks natural areas. This integral public involvement process produced a plan that was derived directly from community input and enhances the quality of the park for future generations.

The Master Plan for Memorial Park consists of a mixture of improvements to existing facilities and development of new park elements that reflect current demand while anticipating future community recreational needs. Elements of the Master Plan identified by the community include; improvements to Murase Plaza, upgraded sports fields, additional and improved picnic facilities, improvements to vehicular, pedestrian and bicycle access, new parking areas, seating, disc golf, relocation of the off leash area, restoration of natural areas and improved connections to the Willamette River. These modifications have been strategically located to preserve and enhance the natural features of the park and to minimize impacts to adjoining neighborhoods.

The proposed Master Plan strategically balances improvements to help guide future development of the popular park, ensuring Memorial Park will continue being a landmark destination within the community of Wilsonville.



Murase Plaza Water Feature



Existing Dock



Forest Trail



Existing Community Garden



Figure 1 - MEMORIAL PARK AERIAL IMAGE

PAGE LEFT INTENTIONALLY BLANK



II. INTRODUCTION

PARK HISTORY

Memorial Park is the City of Wilsonville's oldest and largest park. The property was acquired by the City in 1968 at a size of 61 acres. Additional land was acquired by the City in 1987, 1993, and 2007 resulting in the park's current 126 acre size. The park has a rich cultural history. Forester Ernest Kolbe planted a significant amount of tree species throughout his summer home property during the 1950's, which would later become a portion of the park. German metalsmith Gustave Stein built the Stein Homestead Barn in 1901. The Stein Barn was later purchased by Charles and Lucile Boozier whom later sold 61 acres of land to the City of Wilsonville in 1968 and remaining acreage to the City in 1993.

The park has become a cherished resource for the community and offers a diversity of active and passive recreational opportunities. Murase Plaza, at the intersection of SW Wilsonville Road and Memorial Drive has become the community's front porch. Opening in 2006, the interactive water feature at the plaza attracts thousands of visitors every year. Today, the park is home to Wilsonville's only public athletic fields, skateboard area, off-leash dog park and tennis courts. Other amenities include rentable shelters, basketball, sand volleyball, picnic facilities, a community garden and a variety of walking trails.



Ernest Kolbe informational signage

MASTER PLAN APPROACH

The community has utilized Memorial Park for generations and knows it as a place to recreate, to hold civic events, to cherish natural areas and to honor its history. The Master Plan reflects these traditions and seeks to support and expand the unique qualities of the park and community.

The Master Plan seeks to balance the community's current needs and identify areas and activities for the future. Based on in-depth dialogue with the community, the Master Plan establishes a balance of passive and active recreation, seeks low cost high return improvements, identifies revenue generating activities and provides a high quality recreational experience for the community.

Wilsonville is a growing community outpacing many communities in the Metro area. The city's demographics are also evolving, bringing increased need to provide new types of activities in the park. The plan's improvements were derived through collaboration and the best thinking of citizens and stakeholders to truly reflect community interests and enhance the character of the park for generations to come.

Key components of the plan include: increasing trails, embracing the river, balancing passive and active recreational opportunities, balancing natural preservation with recreation, providing field sports for the growing population, and providing alternative recreational opportunities.

SUSTAINABLE DEVELOPMENT AND CARE

The City seeks to be sustainable in its development practices and effective in its use of funding. The Master Plan reflects this approach in retaining significant components of the park and making improvements rather than wholesale change. Over the life of the park, a primary resource-consuming element is the maintenance. The replacement, repair and general upkeep of facilities, equipment, lighting, lawn, planting, paving, and other elements are a long-term cost. The Master Plan establishes a framework for Memorial Park that can be constructed efficiently and sustainably, improves the environment health of its natural resources, and can be effectively maintained over the long term.



Existing Walnut Grove



Existing Off leash Area



Existing dock



Existing Off-leash Area



Existing play area and ballfield access path

PAGE LEFT INTENTIONALLY BLANK



III. PUBLIC INVOLVEMENT

COMMUNITY INVOLVEMENT

The combination of stakeholder interviews, public meetings, discussions with the city and interaction through the City's website have guided the development of the Master Plan. A series of Open Houses employed a variety of engagement methods to reach people of all ages, backgrounds and walks of life. To identify the appropriate mix of uses, revenue generating resources, and sequence of future improvements, the community engaged in a dialogue that examined the current park and determined aspirations for the future. Key groups included: The City's parks and recreation, engineering and natural resources departments, neighbors and concerned citizens, and user groups such as sports leagues, dog owners, and other citizen groups.

STAKEHOLDERS

The design team conducted a series of stakeholder interviews with community members identified by the City. Stakeholders include a range of groups and leagues who actively use sports fields as well as groups that passively use the park. These conversations enabled the project team to learn directly from people most connected with the Park. Meeting notes were produced and are provided in the appendix. Key components identified by stakeholders that the master plan should consider were:



Public open house

- *Updating ball fields for extended use and programming flexibility
- *Increasing parking quantity and quality
- *Improving rest room facilities
- *Exploring the potential for concessions
- *Addressing security concerns
- *Exploring covered court sports
- *Providing accessible trails

PUBLIC OPEN HOUSES

The open houses began with a presentation of the findings to date followed by facilitated conversations with the public about their aspirations for the park and challenges and opportunities the park provides.

PUBLIC OPEN HOUSE ONE

The first public open house took place on November 5th, 2014 where the design team presented current conditions of the park, site analysis, and key considerations. Various diagrams of the park were presented describing contextual relationships, regulatory and environmental overlays, circulation, access, time of year field use, and existing environmental areas. A list of potential program elements was also presented to gauge interest in various recreational activities. This analysis generated a discussion with citizens about potential new activities and improvements to the park that would serve both current and future needs of the community. Key points identified during the first public open house included:

- *Desire to Increase flexibility of ball fields
- *Enhancing connections to the river
- *Maintaining privacy to adjacent neighborhoods
- *Safety
- *Increasing trail types and accessibility
- *Increasing pickleball and skateboard opportunities
- *Clarifying vehicular and pedestrian circulation
- *Improving parking
- *Increasing seating opportunities
- *Improving accessibility throughout the park
- *Enhancing passive recreation
- *Embracing the park's history

PUBLIC OPEN HOUSE TWO



Public open house

The information gathered through stakeholder meetings, input from the parks department and other city officials, and synthesized from group discussions in the first open house directed the development of three concepts presented at the second public open house on December 14th, 2014.

The three concepts provided a variety of configurations of new recreational elements and improvements to existing facilities that considered present and future needs. The concepts were presented to the group, including the pros and cons of each configuration. Community members and the design team then discussed the merits of the three different concepts. Robust conversations from community members regarding each concept provided the design team with invaluable insight. Balancing passive and active recreation and natural area preservation were identified as important elements when considering new recreational opportunities. Additional key points identified during the second public open house included:

- *Provide Visual access to the river, not physical access
- *Minimizing the removal of trees
- *Improving Memorial Drive crossing
- *Balancing passive and active uses
- *Maintaining the park's current vegetated buffers at its edges

- *Providing light watercraft access
- *Providing a variety of trails
- *Exploring the use of synthetic turf fields

PUBLIC OPEN HOUSE THREE

The final open house took place on February 18th, 2015. Community input from the previous two open houses, interaction through the city's website, and an online survey that generated over 600 responses from the citizens directed the design of the preferred Draft Master plan, where desired components of the three concepts were synthesized into a single plan. Similar to previous open houses, the preferred draft master plan was discussed in an open public format with community members. Valuable community input was received for further refinement of the draft plan. Key points identified during the third open house include:

- *The Dock is busy during summer, light watercraft will add to busyness
- *The Regional trail alignment along the west side of the park was preferred
- *Retaining existing trails adjacent to the river is desired
- *Maintain field #5 for girl's softball and young users
- *The Disc golf course size is family friendly, not sized for advanced players
- *Synthetic fields as shown is preferred
- *Providing storage for ball field equipment

ONLINE SURVEY

Over 600 community members participated in an online survey developed by the Wilsonville Parks and Recreation Department. Those who responded represented a broad cross section of the Wilsonville community, providing valuable perspective as to how the community uses the park currently and their vision for Memorial Park's future. The survey consisted of 10 questions illuminating the demographics of users, popular current park uses and desired future park uses. Key demographics uncovered by the survey include: park users are a mix of ages, majority arrive by car, 40% use the park weekly, with the highest use on weekend afternoons and weekday evenings. The highest existing uses of the park are sports fields, trails, playgrounds, and Murase plaza. The most desired uses are river access and river views, watercraft launch, and sports fields.

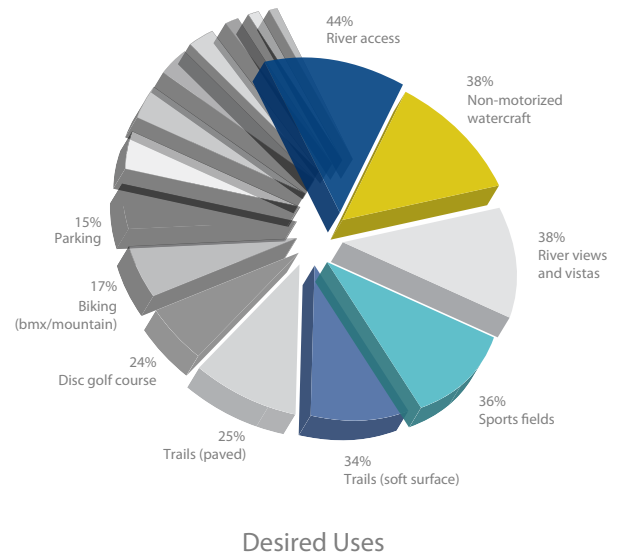
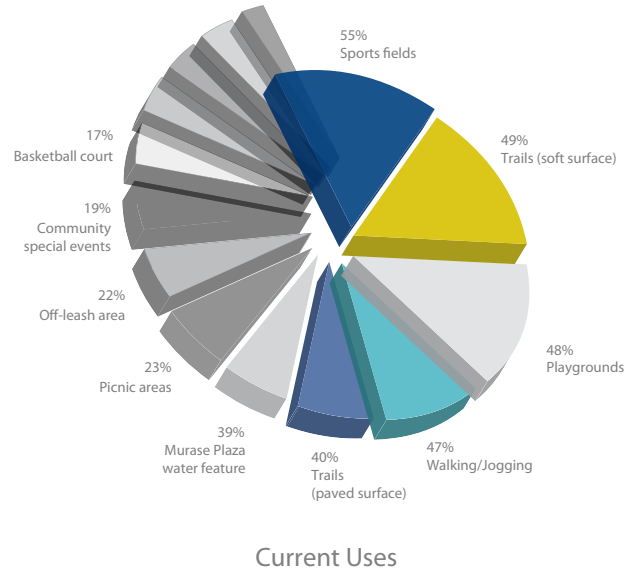

Figure 2 - SURVEY RESULTS: CURRENT AND DESIRED USES

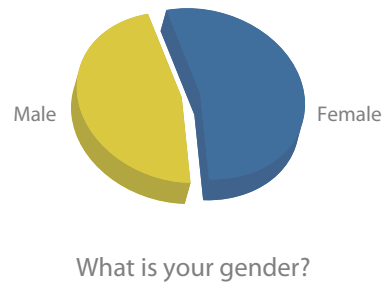
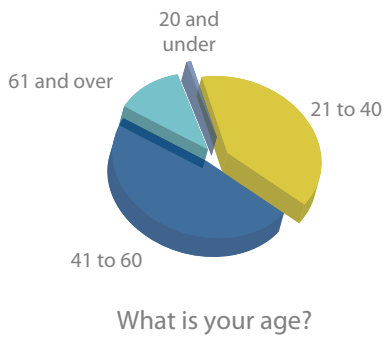
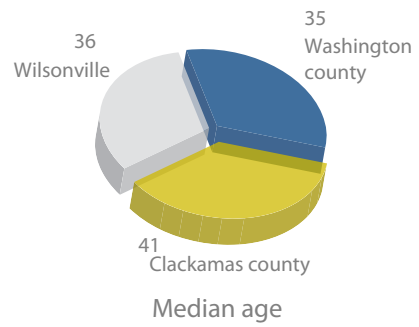
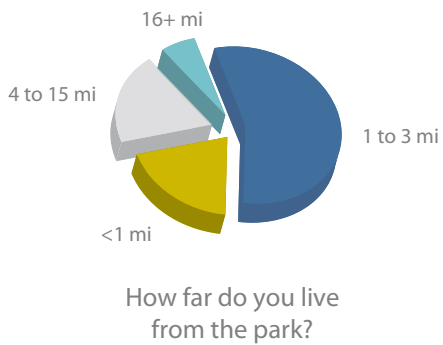
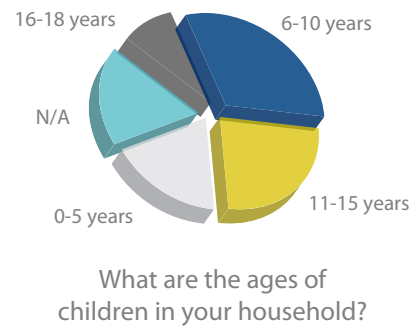
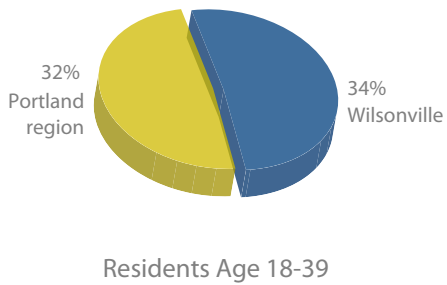
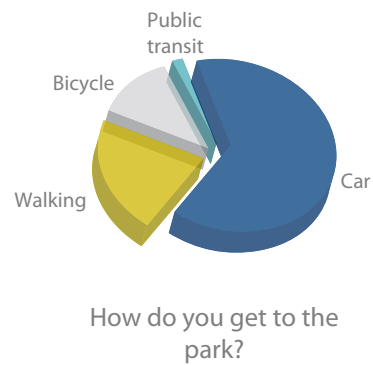
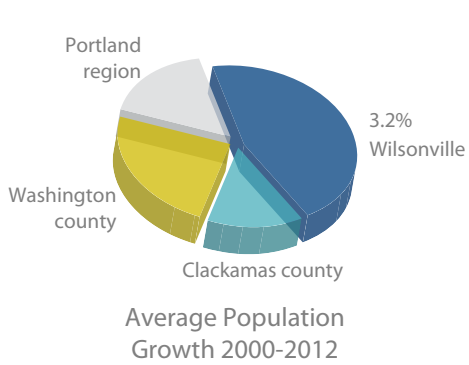

Figure 3 - SURVEY RESULTS

PAGE LEFT INTENTIONALLY BLANK



IV. SITE ANALYSIS

SITE ANALYSIS

Prior to the first public open house, the design team conducted an extensive site analysis process that examined the existing conditions of Memorial Park. This included researching documentation and previous planning efforts, site visits to review park conditions, data gathering using geographical information systems (GIS), and mapping existing physical attributes. The site analysis phase included reviewing and documenting existing park elements, uses, circulation, vegetation classifications, topographical, and architectural elements present in the park. Additionally, the design team worked with the Wilsonville Parks and Recreation Department to understand the existing uses of the park and how events, rentals, sports fields, and other facilities currently function.

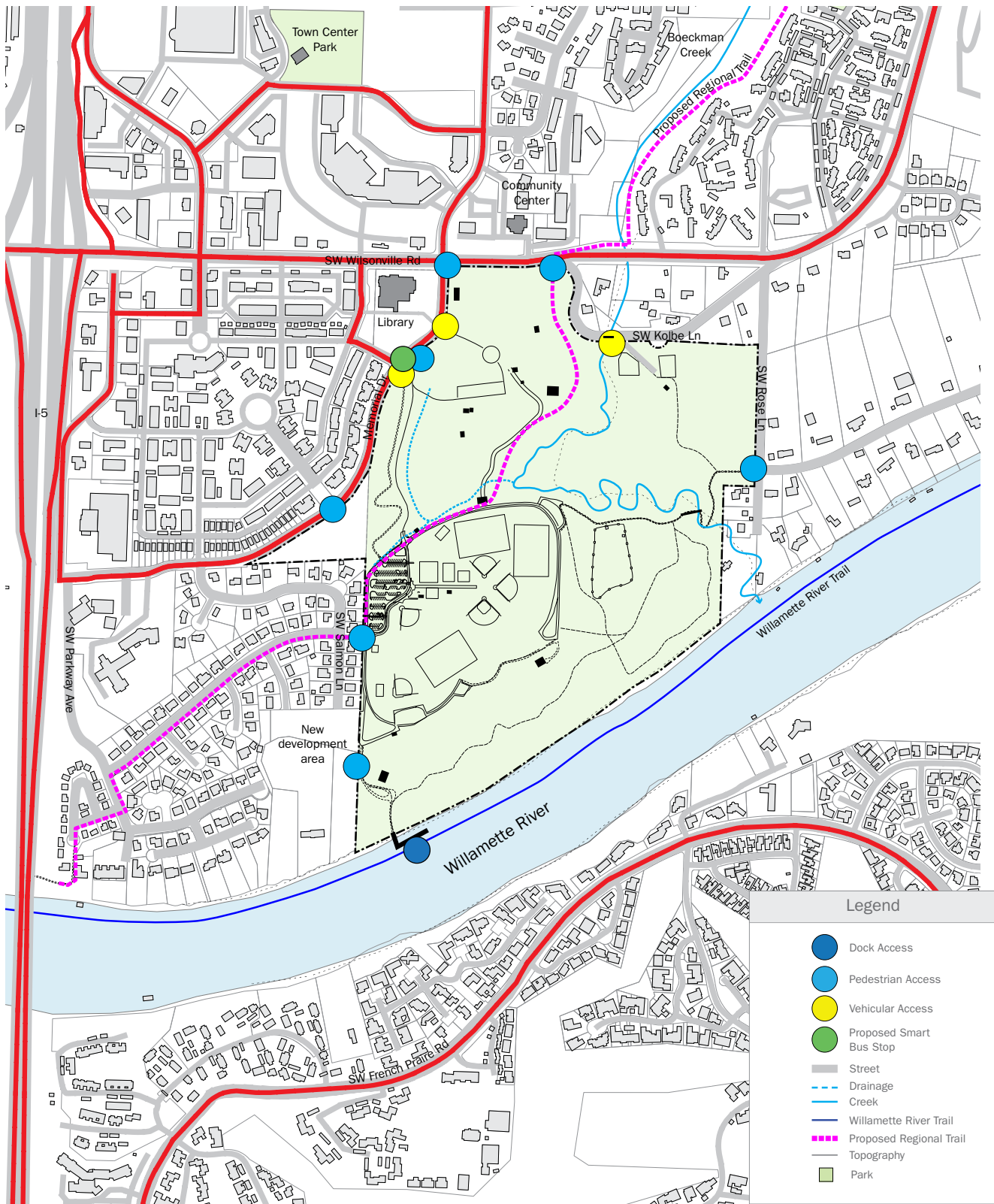

Figure 4 - CONTEXT ANALYSIS

The interface between Memorial Park and adjoining communities is important for providing safe and efficient access by different modes of transportation. The context analysis diagram highlights the existing types of access points and prominent circulation routes to and through the park.

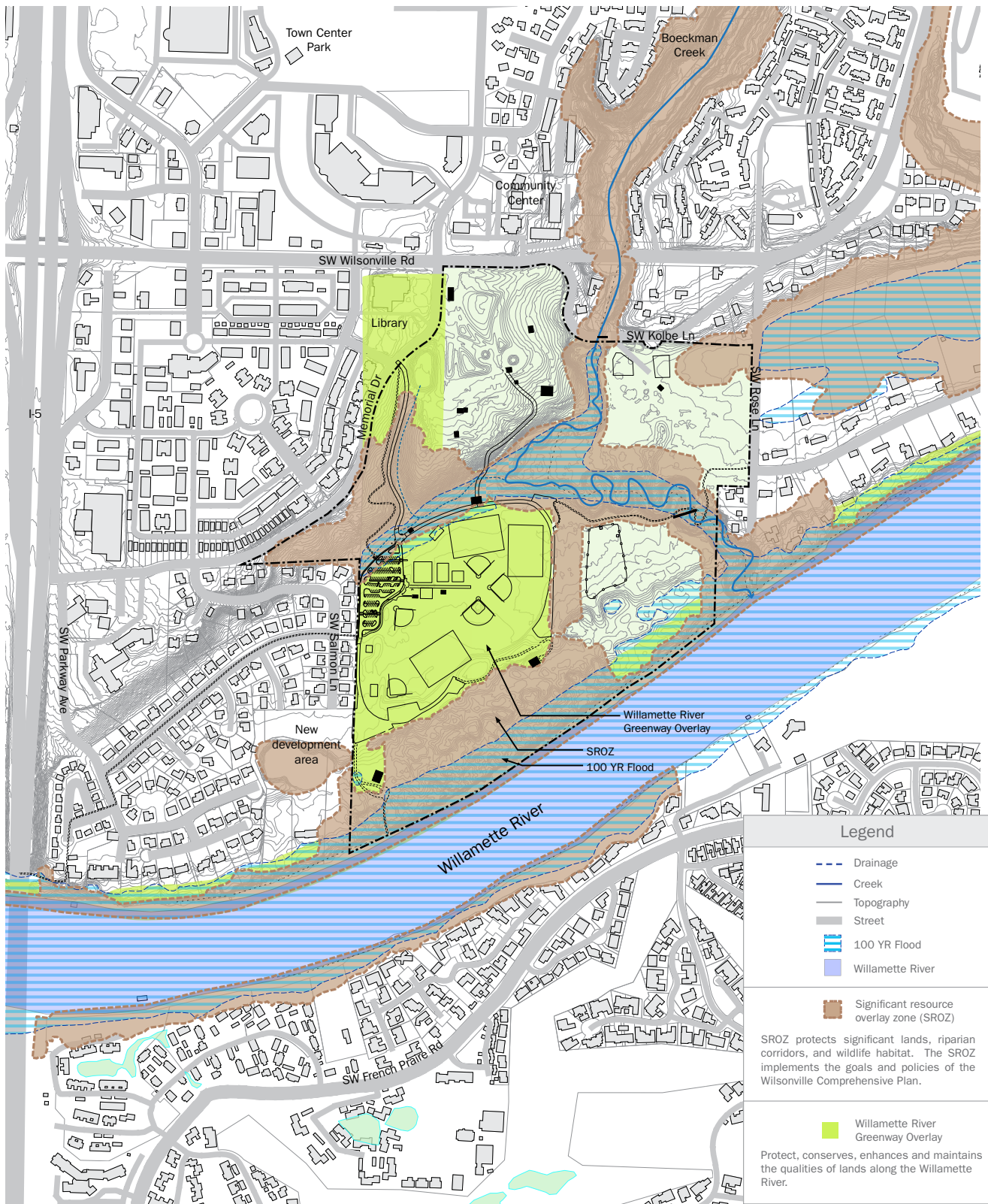

Figure 5 - REGULATIONS

Regulatory overlays provide development guidelines to protect and enhance natural areas and those adjacent to the Willamette River. The diagram maps the overlay zones that effect development within the park. These include the 100 year flood plain, Significant Resource Overlay Zone (SROZ), and Willamette River Greenway Overlay.

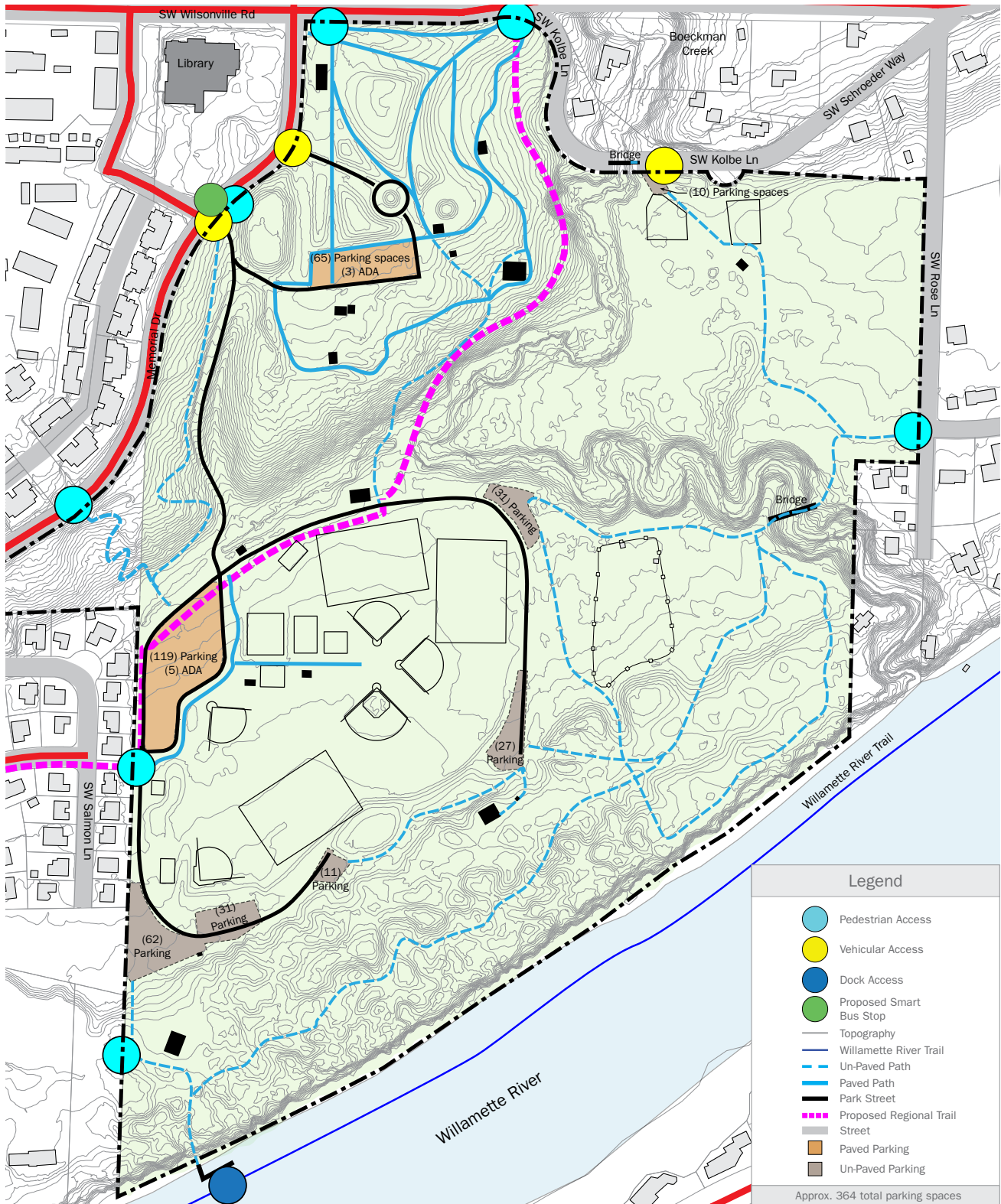

Figure 6 - CIRCULATION

Cohesive circulation throughout the park is important for safety, emergency access, user access, and way finding. The diagram maps existing locations and types of access, streets, paths, and trails. Parking lot locations and quantities of parking spaces are shown.

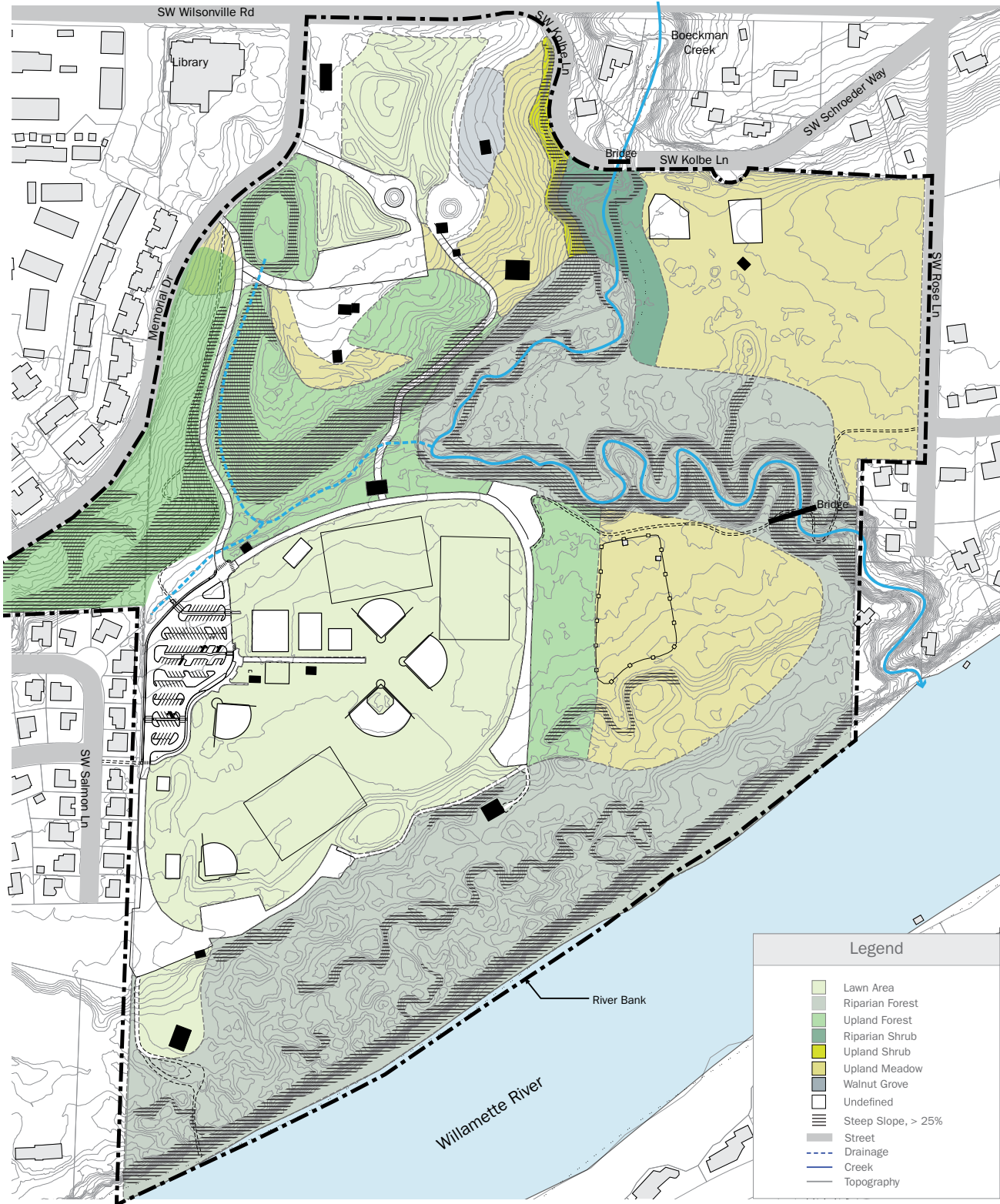
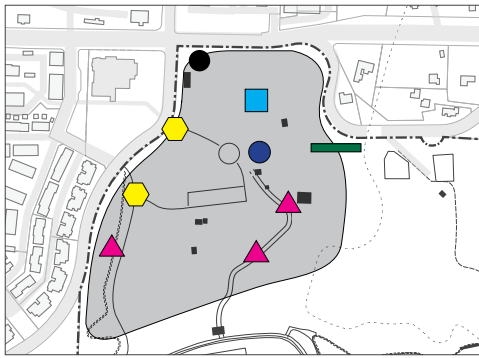
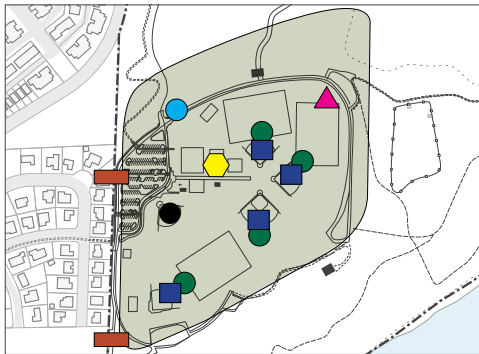

Figure 7 - VEGETATION

Natural areas are valuable resources within Memorial Park. The diagram indicates different vegetation zones, ranging from lawn areas to significant riparian forests. Steep slopes and drainages including Boeckman Creek and the Willamette River are also shown.



- MURASE PLAZA**
- High Use Area
 - Under-Utilized Amphitheater
 - ▲ ADA Accessibility Challenges
 - ⬡ Confusing Vehicular Access
 - Potential Connection to East Side
 - Safety and Play Value Improvements



- WEST**
- Lighting Improvements at Field #4
 - Pump Station Re-Location- Planned
 - ▲ Drainage and Irrigation Equipment Conflict
 - ⬡ Desire for Expanded Recreational Opportunities
 - Sports Field/Portable Fencing Improvements
 - Desire for Infield Expansion
 - Neighborhood Proximity Concerns

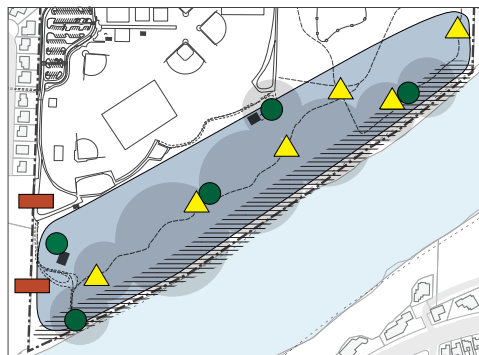

- RIVERFRONT**
- ▨ Potential River Access
 - Security and Safety Concerns
 - ▲ Trail Improvements
 - ADA Accessibility Challenges
 - Neighborhood Proximity Concerns



- EAST**
- ▨ Available Area for Possible Use
 - Community Garden Expanding to 120 Plots
 - Off-leash Area Maintenance
 - Parking Quality and Location
 - ▲ Limited Pedestrian Access From West Side
 - Natural Areas Benefits

Figure 8 - CONSIDERATIONS

These diagrams indicate elements requiring consideration during the master planning process. The considerations are highlighted per area (Murase Plaza, West, Riverfront and East). Issues such as access, security and safety, connections, and opportunities and constraints are included.

Park Amenities	
Boomer Furry Park	Soccer Fields
Canyon Creek Park	Baseball/Softball Fields
Courtside Park	Basketball Court
Edelweiss Park	Sand Volleyball
Engelmann Park	Tennis/Pickleball
Graham Oaks (METRO)	Skate Park
Highway Wood	Childrens Play Area
Memorial Park	Interactive Water Feature
Murase Plaza	Off Leash Dog Area
Palmer Park	Walking Trails
Park at Merryfield	Barbecue Grill
Picadilly Park	Picnic Tables
River Fox Park	Public Restroom
Sofia Park	Ramtable Shelter
Town Center Park	On Site Parking
Tranquil Park	
Water Treatment Plant Park	
Willow Creek - Landoner Park	

Figure 9 - WILSONVILLE PARK SYSTEM AMENITIES

The diagram of Wilsonville’s park system indicates park amenities present in each park. The diagram highlights the importance of Memorial Park and Murase Plaza in providing recreation for the community.

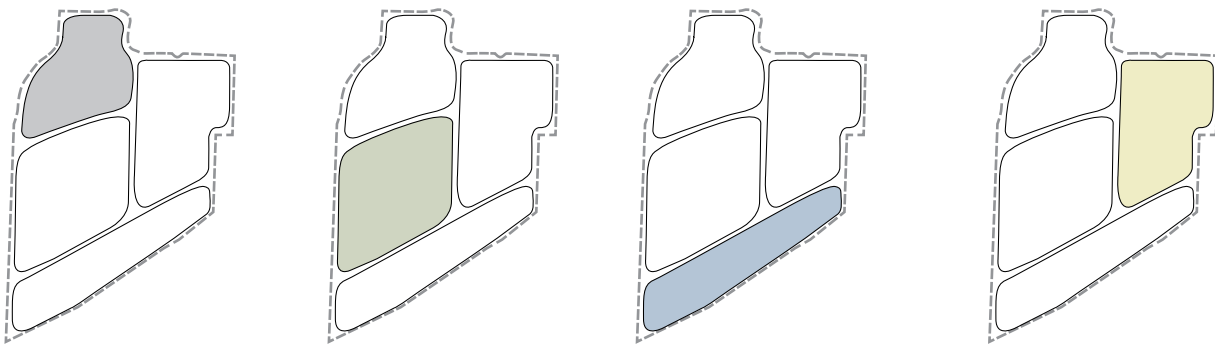

MURASE PLAZA
8.5 acres lawn
13.5 acres forest

- Water Play
- Walking / Running
- Picnic
- Playground
- Biking
- Stein-Boozier Barn

WEST
19.8 acres lawn
6.8 acres forest

- Baseball / Softball
- Soccer
- Flag Football
- Ultimate Frisbee
- Sand Volleyball
- Tennis
- Pickleball
- Basketball
- Skateboarding
- Walking / Running
- Horseshoes
- Biking

EAST
16.9 acres forest
15.1 acres meadow

- Walking / Running
- Biking
- Community Garden
- Wildlife Viewing
- Dog Park

RIVERFRONT
0.8 acres lawn
23.5 acres forest
2.6 acres meadow

- Events at Shelters
- Walking / Running
- Biking
- Movie nights (4) at River Shelter
- Boating
- Fishing

Figure 10 - MEMORIAL PARK AMENITIES

The diagrams show approximate acreage of lawn, forest, or meadow in each region of the park. Existing amenities, passive and active uses of each region are listed.

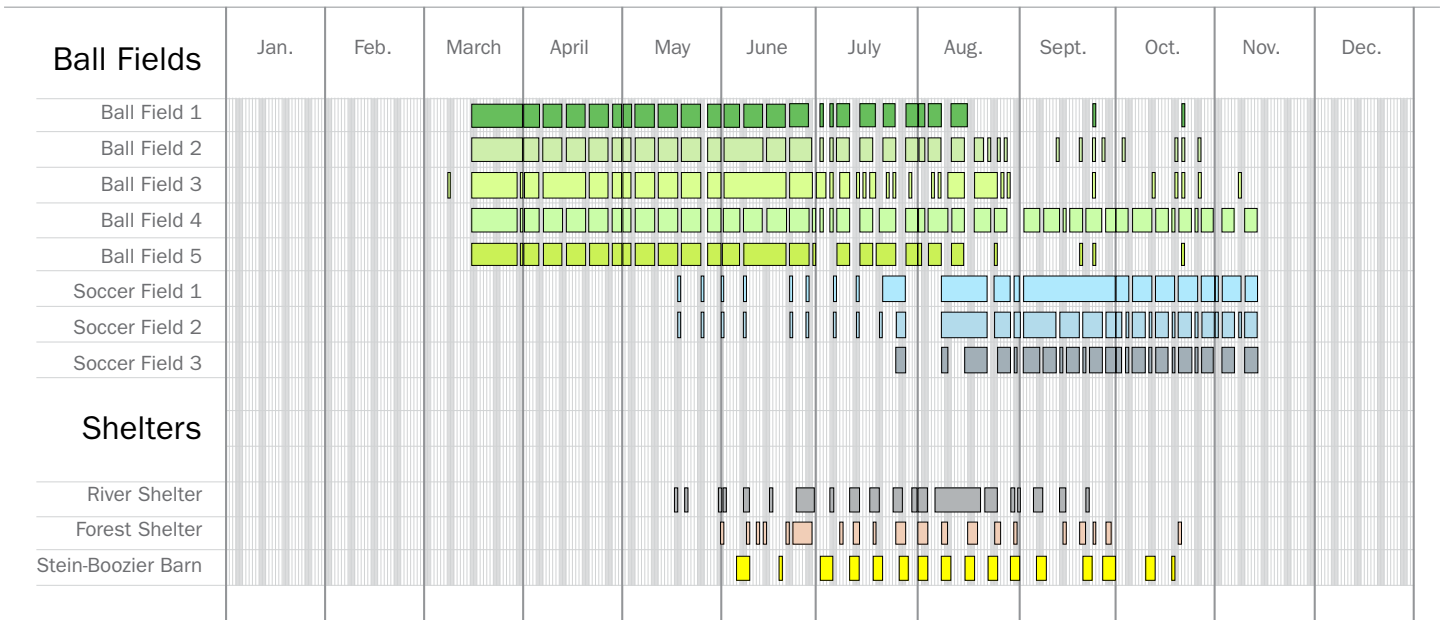

Figure 11 - BALL FIELD AND SHELTER TIME OF USE

Two primary programmatic components of Memorial Park are ball fields and rentable shelters. The diagram displays their time of use during 2014 and indicates the intensity of use in the summer months.

PAGE LEFT INTENTIONALLY BLANK



V. INITIAL CONCEPTS

CONCEPT OPTIONS

With the site analysis, community comments and input from city's Parks and Recreation department, the team prepared three alternative concepts to illustrate potential options for Memorial Park. The concept plans proposed a range of recreational opportunities in a variety of locations with a diversity of ways to treat active and passive uses in the park. The options also varied regarding the impact of development to existing park features. Several improvements were common in all three concepts.

IMPROVEMENTS CONSISTENT TO ALL CONCEPTS

- *Improved safety of the intersection at Memorial Drive and Public Library access road.
- *Terraced seating at Murase Plaza fountain
- *Improved amphitheater area with terraced seating at Murase Plaza
- *Provide accessibility to Stein-Boozier Barn and upgrade the barn's exterior spaces.
- *New path from Murase Plaza east across the existing pedestrian bridge off Kolbe Lane.
- *Maintain River Shelter and Forest Shelter locations.
- *Improve clarity of trail system.
- *New parking lots to south and east of ball fields with restroom facilities
- *Relocated skate spot northeast of ball fields
- *Improve ball field traditionally wet areas and various infield and outfield maintenance issues. Fields lighted.
- *Enlarged Community Gardens
- *Relocated off-leash dog area
- *New Vegetated buffers at West and East neighborhoods.
- *Preserve and enhance natural areas.



Figure 12 - Concept Option 1

CONCEPT OPTION 1

- *Regional trail eastern alignment
- *Infields enlarged at Ball fields 1,2,3
- *Ball field 5 removed
- *Maintenance Barn converted to rentable Picnic Shelter, new maintenance building at upper maintenance facility yard
- *Additional pickle ball courts and basketball courts
- *Four overlooks at riverbank with views to the river
- *Arboretum with walking trails at southeast area of the park
- *New parking lot off of Kolbe Lane with Community Gardens, off-leash dog area and Restroom
- *9 hole disc golf course in the northeast area of the park



Figure 13 - Concept Option 2

CONCEPT OPTION 2

- *Regional trail western alignment
- *Infields enlarged at Ball fields 1,2,3
- *Ball field 5 shifted east
- *Bike pump track and skills course at northeast corner
- *Small meadow openings along river trail
- *Three overlooks at riverbank with views to the river
- *Light watercraft drop off and launch at existing dock
- *Additional pickle ball courts with covered structure
- *Off-leash dog area near east parking lot
- *9 hole disc golf course in the southeast area of the park
- *New parking lot off of Rose Lane with Restroom



Figure 14 - Concept Option 3

CONCEPT OPTION 3

- *Regional trail western alignment
- *4 new enlarge ball fields with soccer field overlay
- *Re-aligned park road at ball fields
- *Enlarged existing parking lot at ballfields
- *Court sports, ball field restroom and play area moved southwest
- *Maintenance Barn converted to rentable Picnic Shelter, new maintenance building at upper maintenance facility yard
- *Additional pickle ball courts
- *Large beach area with meadows, a shelter with restrooms, large lawn area, beach volleyball and large views to the river
- *Three overlooks at riverbank with view shed to Willamette River
- *Two soccer fields east of existing ball fields
- *Bike pump track and skills course south of new soccer fields
- *Wetland and Meadow Gardens and trails
- *New parking lot off of Rose Lane with off-leash dog area and Restroom

PAGE LEFT INTENTIONALLY BLANK



VI. PREFERRED OPTION

MASTER PLAN

The Master Plan (Figure 15) is a result of desired elements of the three concepts, guided by community input from open houses and other citizen input, interaction with stakeholders, the online survey and direction from the Wilsonville Parks and Recreation Department. The Master Plan depicts the proposed layout and location of new amenities, existing facilities to remain and existing facilities to be improved.

Specific attention has been given to clarifying the vehicular and pedestrian access into the park. The parks circulation system has also been enhanced by defining a clear trail hierarchy consisting of major, minor and secondary trails creating a variety of loop walk options guiding users through a series of habitat types.

Active recreation remains the focus of the western portion of the park. The sports fields are updated to provide for programming flexibility, year around use and safer field conditions. Additional court sports are included in response to growing popularity of pickle ball and the communities need for additional tennis courts. Memorial Parks mission as a regional park is to serve a broad range of traditional and alternative recreational needs. New uses such as a bike pump track and disc golf course continue the mission by introducing activities the city does not currently have in the park system.

Passive recreation is also a large part of the current and future of Memorial Park. Interconnected walking trails move visitors through a variety of environments. A future regional trail is planned to connect through the park. A new light watercraft launch provides the public with a means of interacting with the Willamette River and river trail. Community gardens, off-leash dog area, picnic areas and disc golf provide additional passive opportunities.

Emphasis was given to the preservation and enhancement of the natural environment. Dense mature stands of upland and riparian forests are maintained with low impact walking trails guiding visitors through. Park amenities have been kept away from Boeckman Creek and its riparian corridor. Open meadows with historically significant specimen trees have been protected. Views to the Willamette River have been provided at key overlook areas to visually connect to the river.



Figure 15 - MASTERPLAN



Figure 16 - ENVIRONMENTAL PLAN

The plan calls for protection and enhancement of significant natural resource areas. The Boeckmen Creek riparian corridor, forest, and meadow areas are maintained beyond the large active gathering areas such as sport fields and playgrounds.

PARK AREAS

For clarity, the master plan is discussed in four areas: Murase Plaza, West, Riverfront, and East to provide detail of the park spaces, character, composition and relation to adjacent elements and the neighboring community.

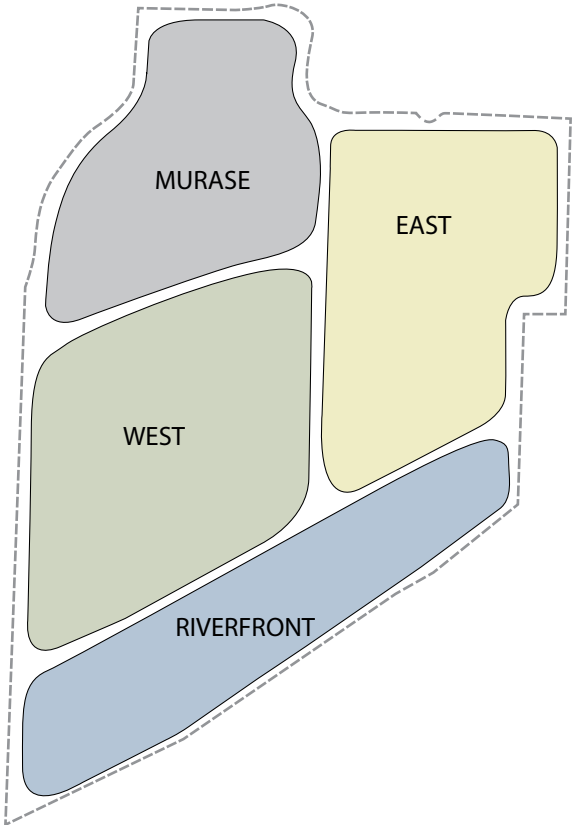
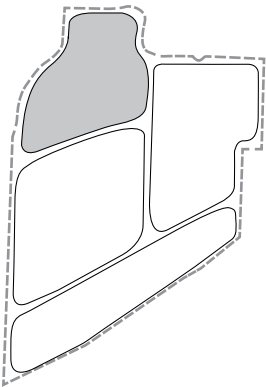



Figure 17 - MURASE PLAZA AREA ENLARGEMENT



Murase Plaza Area

- 1 New Terraced Seating
- 2 Updated Amphitheater with Stage
- 3 New Regional Trail
- 4 New Playground
- 5 Maintenance area with New Maintenance Building
- 6 Stein-Boozier Barn
- 7 New Accessible Route to Stein-Boozier Barn
- 8 New Gathering Space
- 9 New Trail from Parking Lot
- 10 New Trail to East with Stairs
- 11 Boeckmen Creek
- 12 Existing Parking Lot
- 13 Existing Walnut Grove
- 14 Existing Covered Picnic Area
- 15 Existing Pedestrian Bridge
- 16 Improved Pedestrian Crossing



Existing Amphitheater- Opportunity for Improvement



Grass Berm - Opportunity for Terraced Seating



Existing Walnut Grove to be Preserved



Stein-Boozier Barn - Access Improvements

MURASE PLAZA

Operating as the ‘front porch’ of Memorial Park, Murase Plaza is cherished and highly used. Improvements are proposed for the Murase Plaza area to enhance its functionality, character, and preserve historical and natural elements.

SEATING AND AMPHITHEATER

Increased seating has been requested by the community adjacent to the existing water feature at Murase Plaza (1, figure 17). The grass knoll southeast of the water feature provides an opportunity for terraced seating that will serve demand during peak use. Improvements to the existing amphitheater are provided including re-grading of the land to create terraced seating that accommodates 200 people for events (2, figure 17). The stage area is improved to support small performances such as musical groups or children’s theater while the existing walnut grove beyond is maintained as a beautiful natural backdrop.

EXISTING FACILITIES AND CIRCULATION

The existing parking lot, entry drive, bathrooms, playground, picnic shelters, and Stein-Boozier barn will remain in place. Access and circulation are improved. (16, figure 17) Improvements to the intersection at Memorial Drive and Library entrance provides for a safer access point to the park. A trail and stairs connecting Murase Plaza to the East side of the park is proposed (10, figure 17). The connection to the East side will utilize the existing pedestrian bridge, increasing access to the eastern parks amenities. A new regional trail alignment is planned, weaving from northeast to southwest and connecting Murase Plaza to the lower park areas (3, figure 17).

STEIN-BOOZIER BARN

A small accessible parking area off the existing parking lot connects to a new path providing universal access the Stein-Boozier barn. The barn also receives improvements to the gathering spaces on the north and south sides, accommodating revenue generating events such as weddings and corporate events. These improvements include upgraded surfacing, additional seating and planting.



Figure 18 - WEST AREA ENLARGEMENT

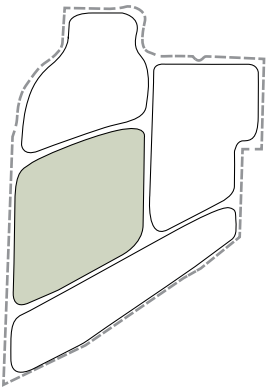

West Area

- 1 New Regional Trail
- 2 New Picnic Shelter with Restroom
- 3 New Pump Station
- 4 New Skate Spot
- 5 New Parking
- 6 Restroom Improvements
- 7 New Nature Based Play
- 8 (2) New Tennis Courts
- 9 (2) Existing Tennis Courts
- 10 (2) New Covered Pickle Ball Court
- 11 (2) Existing Pickle Ball Courts
- 12 Update shelter with new Concessions
- 13 New Synthetic Turf Soccer
- 14 New Synthetic Turf Ballfield
- 15 Natural Turf Soccer and Ballfields
- 16 Open Lawn
- 17 Basketball Court, (1) full court (south) and (2) 1/4 courts (north)
- 18 Sand Volleyball Courts
- 19 Boeckmen Creek
- 20 Existing Parking
- 21 New Vegetated Buffer
- 22 New Synthetic Turf Area
- 23 Existing Play Area with new perimeter fence
- 24 Multi-use path with emergency / service access
- 25 Forest Shelter Improvements



Existing Ballfield



Pickleball Example



Sand Volleyball Example

WEST AREA

The West area of Memorial Park contains major programmatic elements including ball fields, open lawn, parking, play areas, court sports and shelters.

SPORTS FIELDS

Ballfields 1,2,3,4 remain in their current locations. Ballfield 5 shifts to the east, sharing space with the open unprogrammed lawn space. The fields are significantly updated with lighting, dugouts, backstops, foul ball protection and seating improvements. Portable outfield and foul territory fencing provides flexibility at all fields to efficiently switch sports of field sizes. Ballfields 1 and 2 are upgraded to synthetic turf with drainage below (with future consideration for ballfield 3), increasing the usability of the fields in terms of scheduling efficiency and seasonal extension (shown as dark colored turf, Figure 18). The synthetic turf area is extended beyond the fields to the northeast providing a flexible use/warm up space. The remaining fields and open lawn space, likely renovated, will remain natural turf.

SPORTS COURTS

Two existing tennis courts remain in place with two new courts to the north. The courts are striped for pickleball use as well. Two existing uncovered pickleball courts remain with two new covered pickleball courts added. A covered spectator seating area with bleachers allows spectators to watch tennis or pickleball while sheltered from the elements. Two basketball hoops with 1/4 courts are provided adjacent to tennis and pickleball for casual play. A concession building is proposed near the court sports and ball fields (12, Figure 18). The concession building has covered seating areas and can be used as registration and ceremony space for events. On the south side of the open lawn area one basketball court and two sand volleyball courts are proposed.



Nature Play Example



Future Picnic Shelter with Restroom



Paved Path Example



Existing Parking Lot

PLAY

The existing play area adjacent to the primary pedestrian corridor will remain and be upgraded with child security fencing (23, figure 18). A nature based play loop is incorporated offering children an alternative play experience integrated into the parks mature forest (7, figure 18). A new skate spot is located the east of the access road for safety and surveillance 4, figure 18). The skate spot is designed specifically to preserve mature trees, integrating them into the skate area.

STRUCTURES

Several new structures are proposed: (1) new restroom (6, figure 18) at the eastern parking lot, (1) shelter with concession at sports fields, and a new lift station to be installed. Existing facilities that will remain in place and receive upgrades to accommodate new use/capacity include: Rest room at sports fields (6, Figure 18), and existing maintenance barn to be converted to rentable picnic shelter (2, Figure 18). The Forest shelter will receive improvements to its structure as well as site improvements including removing the berm to visually and physically to provide greater connectivity to the ballfields

TRAILS

Several trail types are proposed. The paved regional trail connects to the west into the adjoining neighborhood. A 12' major paved path runs along the southern edge of ballfields. The major path connects the two new parking lots together, providing emergency and service vehicle access as well as access to the lift station during a 100yr flood event. Soft surface trails connect to the major 12' trail. Bench seating is proposed intermittently along the regional trail and major trails.

PARKING

Parking is upgraded to include two new paved parking areas, increasing the total parking count to 434 paved spaces (362 existing including informal gravel lots). The existing paved lot is renovated at the north intersection to clarify park circulation. The new lots are strategically distributed to provide easy access to all park uses, to be safe, and protect significant vegetation.

PAGE LEFT INTENTIONALLY BLANK



Figure 19 - RIVERFRONT AREA ENLARGEMENT

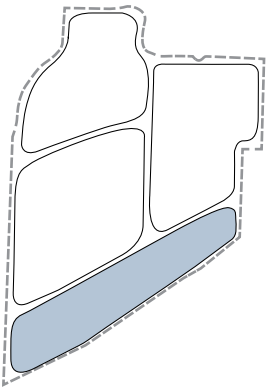

Riverfront Area

- 1 River Shelter
- 2 Improved Forest Shelter with Open Lawn
- 3 New Overlook with View Corridor
- 4 New Access Turnaround
- 5 New River Trail
- 6 New Secondary Trail
- 7 Updated Restroom with New Concession Building
- 8 Improved Gravel Access Road
- 9 New Light Watercraft Launch at Existing Dock
- 10 New Vegetated Buffer
- 11 New Parking Lot
- 12 Top of Bank
- 13 Existing Dock



Light Watercraft Launch Example



Existing River Shelter



Existing River Trail to be Improved



Overlook Example

RIVERFRONT AREA

Proposed enhancement to Memorial Park's riverfront were influenced by the communities desire to better connect to the Willamette River. Proposed improvements enhance the natural areas and increase recreational opportunities along the river.

WATERCRAFT ACCESS

A gated gravel access road (8, figure 19) south of the new parking lot provides vehicle access to a light water craft drop-off area and existing dock. The access road can be closed off as necessary to allow for program flexibility at the River shelter. New dock launches provide accessible water access for all light watercraft users.

SHELTERS

The River Shelter (1, figure 19) remains in place with the desirable open lawn and riparian forest surrounding it preserved. The forest shelter (2, figure 19) will also remain in its current location. Re-grading the near by mounds and steep slopes will provide increased visual access and security, increasing the physical and visual connection to the open lawn and ball field area. A new rest room and concession building (7, figure 19) is provided. The concession building serves dual purposes; a river-oriented concessions for revenue generation, possibly operated by a third party vendor, or a concession area serving various park events at the River shelter such as movie in the park.

TRAILS AND OVERLOOKS

Trail circulation is clarified throughout the riverfront area for ease of way finding and trail identification. The primary river trail will be improved with gravel surfacing to reduce erosion and improve the walking surface. Minor trails and connector trails will remain soft-surfaced. The trail alignment and other trail improvements minimize disturbance to existing vegetation. Where possible trails are graded to meet accessibility requirements. Overlooks are provided adjacent to the river trail, located at the top of bank to maximize views to the Willamette River, while minimizing disturbance of the riparian forest (3, figure 19). Overlooks are planned to be stone walls with benches and sized for small groups.



Figure 20 - EAST AREA ENLARGEMENT

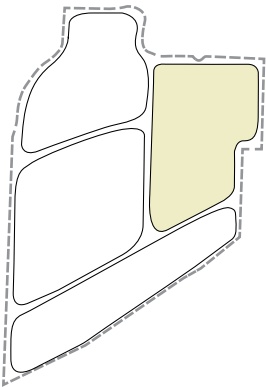

East Area

- 1 New Parking
- 2 New Restroom
- 3 New Bicycle Pumptrack with Skills Course
- 4 New 9 Hole Disc Golf Course
- 5 Boeckmen Creek
- 6 Vegetated Buffer
- 7 Relocated Community Garden Area
- 8 New Access Road
- 9 Relocated Off Leash Dog Area with Shade Shelters
- 10 Relocated Small Dog Area
- 11 Existing Well
- 12 New Pedestrian Access Points
- 13 Meadow
- 14 Wet Meadow
- 15 12' Major Trail
- 16 Pedestrian Bridge



Bicycle Pump Track Example



Disc Golf Example



Existing Community Gardens



Existing Dog Park and Shelters

EAST AREA

Within the East area the Master Plan seeks to balance passive and active recreation, maintain vegetated buffers to the adjoining neighborhood and protect and enhance the forests, meadows and significant vegetation.

PUMP TRACK

The 14,000 square foot bicycle pump track and skills course (3, figure 20) is provided as an alternative sport with an ever growing popularity encompassing a large age range. Wilsonville does not currently have a pump track. The proposed track is sized for community use, positioned near parking and for surveillance and adjacent to the skate spot to share similar active park uses. Programmatically the track can be used for public events, potentially generating revenue.

DISC GOLF

The 9 hole 5.6 acre disc golf area (4, figure 20) is located in a meadow area with large existing individual specimen and new trees. The course is sized for family play. Additional trees are proposed to be planted to enlarge the adjacent riparian forest and increase habitat value. Times of use are established to allow trails crossing the course to be enjoyed by all users at certain times of the day.

COMMUNITY GARDENS AND OFF-LEASH DOG AREA

The 0.6 acre community garden (7, Figure 20), and 1.5 acre off leash area (9, Figure 18) and located off the new access road and parking lot (1, Figure 20) for ease of access and connection to the community. The community garden shift east out to take advantage of full sunlight and is minimally larger than existing to take into account increased users over time. The off leash area is similar size as existing, and includes fencing, re-using the current shade shelters and a small dog area.



Wet Meadow Example



Natural Area to be Preserved



Specimen Tree to be Preserved

TRAILS

Trails are located throughout the east side ushering visitors through a variety of habitats types, including forest, meadow and wet meadow. a main 12' paved trail anchors the trail system providing for clear, understandable way finding. Several pedestrian access points are locating on the east side connecting the park to the neighboring community (12, Figure 20) and providing clear and direct access into the park.

ENVIRONMENTAL

The master plan emphasizes the importance of preserving and enhancing existing natural areas and improving them via additional vegetation to increase biodiversity. Boeckmen Creek is preserved as a significant riparian corridor in addition to the strategic preservation of significant trees throughout the disc golf and pump track areas. A wet meadow is established in the north east corner of the park where seasonal inundation has been documented. Trails weave through various habitats to provide the public with the opportunity to partake in passive wildlife viewing and interpretive environmental education.

Memorial park currently has several locations where the city's Natural Resources Department along with community members have vegetated portions of the park. The master plan seeks to protect these areas where possible while transplanting disturbed vegetation to other locations within the park.

PAGE LEFT INTENTIONALLY BLANK

CIRCULATION AND ACCESS

The master plan clarifies the circulatory systems of the park for safety, ease of access, way finding, and recreational opportunities. The diagram illustrates the Master Plans vehicular access, circulation and parking. The dashed red multi-use path is for emergency and police vehicular access.

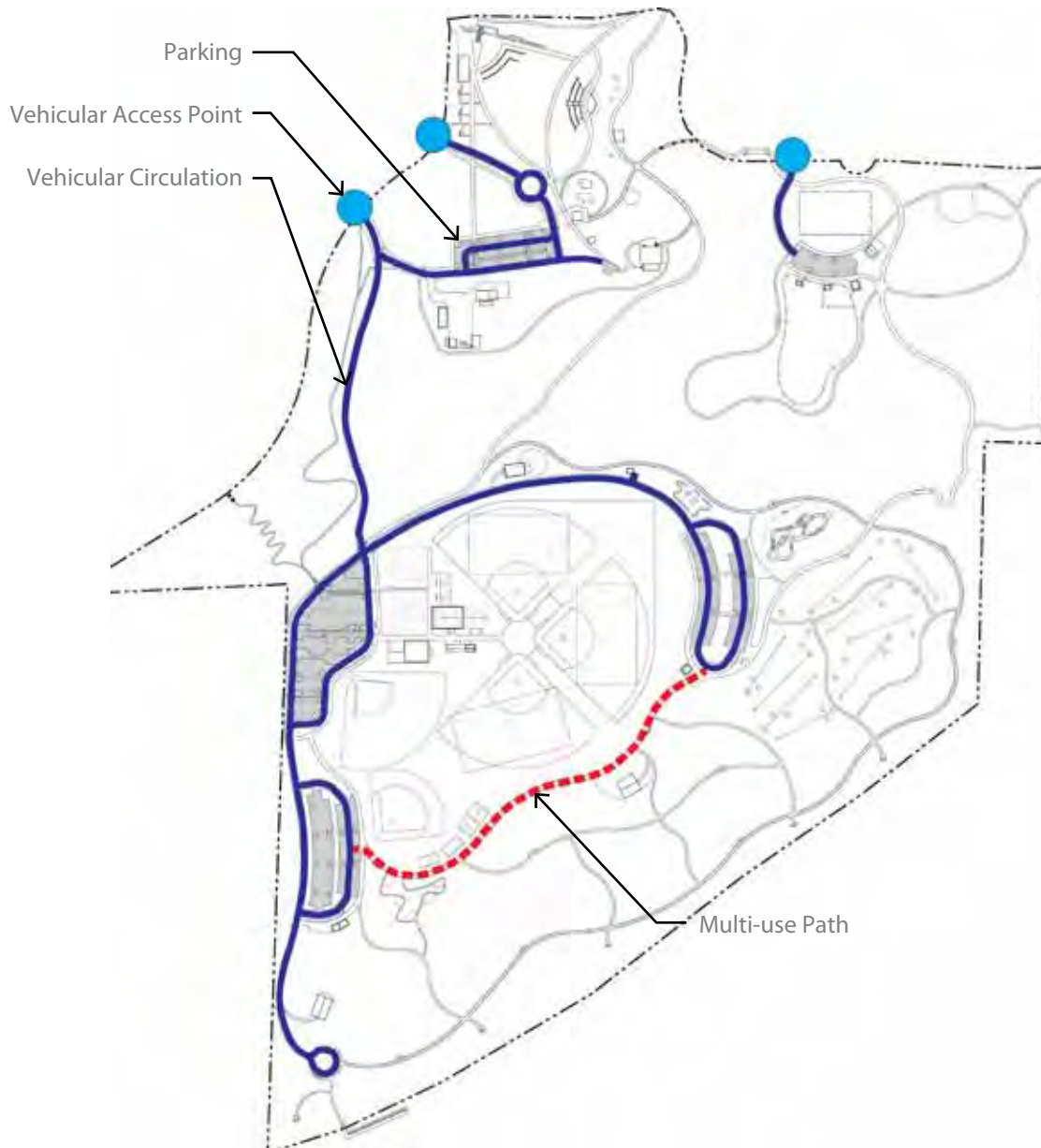

Figure 21 - VEHICULAR CIRCULATION AND PARKING

TRAILS

The master plan includes three distinct trail types. The diagram illustrates the regional trail and major trails. The city currently plans to extend the regional trail North and West beyond Memorial Park. The regional trail is a 12' paved multi use path for bikes, pedestrians and emergency vehicle use. The regional trail is designed to take the user to a variety of public spaces within Wilsonville. Major trails are paved 10' wide multi-use paths for bikes, pedestrians and emergency vehicle use. Utilizing the regional trail and major trails, park users can access all park amenities. Major trails are signed and may be color coded for ease of wayfinding. Major trails may also be named to reflect the environmental habitat they run through, such as a River Trail or historical figures significant to the park, such as a Homestead Trail.



Figure 22 - REGIONAL TRAIL AND MAJOR TRAIL

TRAILS

The diagram shows loops utilizing only major trails, with the exception of the trail adjacent to the Willamette River. Loops may be color coded and signed to provide for casual walking loops or for events, such as cross country running meets.

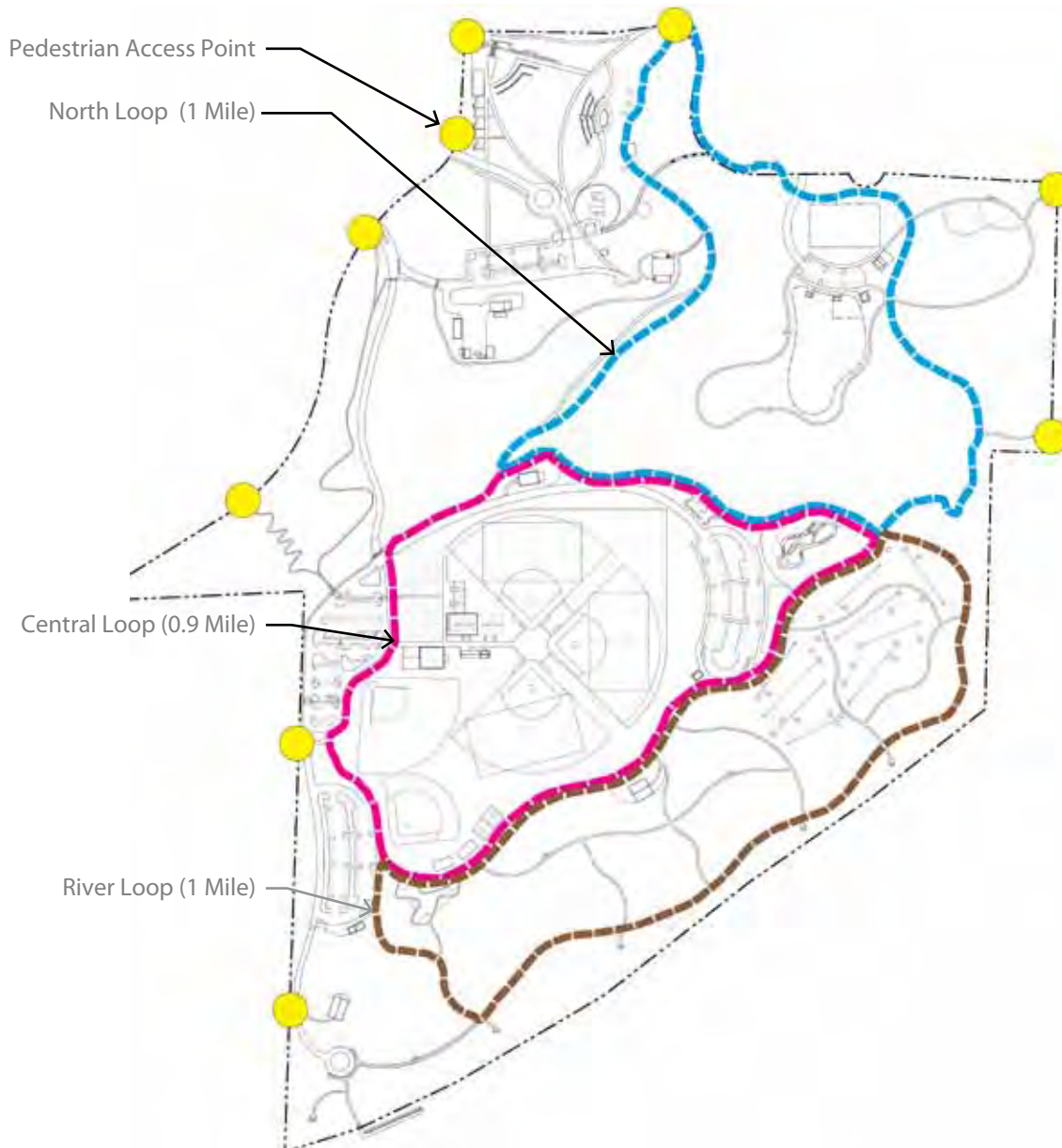

Figure 23 - MAJOR TRAIL LOOPS

TRAILS

The diagram shows locations of secondary trails in addition to major trails, depicting the entirety of Master Plan's trail system. Secondary trails are 4-6' wide and serve as linkages to major trails and connections to adjacent neighborhoods. Secondary trails are paved or soft surfaced depending upon location within the park, accessibility desires, grading conditions and adjacent uses.



Figure 24 - SECONDARY TRAILS

PRIORITIES

The following revenue, operations, maintenance and costing were explored during the Master Plan process to aid the Parks Department and City in determining priorities for future facility upgrades and park development outlined in the Master Plan. As community needs for recreational growth are considered, the financial information presented will assist city officials in determining budget allocation of park amenities to meet the recreational demands as well as provide baseline information to increase current revenue potential.

REVENUE AND OPERATIONS

As part of the Master Plan update, the team reviewed revenue and operation expenses of the current park and for the proposed Master Plan of the park. The full study of park revenue scenarios and potential operation expenses is included in the appendix.

PARK REVENUES

The study addresses the existing revenues and potential revenue scenarios for the preferred master plan. Existing revenue focused on the three existing rentable shelters, while new revenue sources included: Community gardens, Amphitheater/stage, pickleball, bike pump track, disc golf course and a water-based concessionaire. Additional community garden plots and the amphitheater at Murase plaza will generate additional revenue based upon rentable fees. Amenities such as pickleball, bike pump track, and disc golf have potential to host small

tournaments, however the event size may fall below the 250 person minimum for current special use permits; therefore assigning potential revenue to those amenities is not currently feasible. A seasonal water-based vendor near the existing dock provides additional revenue while providing the public with accessible watercraft and water related materials to access the river. In assessing the revenue potential for the parks sports fields, the presumed scenario is that this mix of fields will be utilized for local and metro area tournaments. However, the complex may not be large enough to generate increased utilization of local hotels.

Revenue scenarios (Figure 25) were generated to illustrate potential future revenue. Three scenarios were calculated to include the following:

- *High-growth option, which includes an 80% peak period utilization for the shelters and barn, the installation of a water-based concessionaire, and increased usage of sport and event facilities.

- *Moderate-growth option, which is primarily driven by a 50% peak period utilization for the shelters and barn, along with modest increases in the usage of sport and event facilities.

- *No-growth option, which maintains the utilization of facilities from the 2014 season, in addition to the third picnic shelter and community gardens.

The primary intent of these scenarios is to illustrate the revenue potential for the park, given its wealth of reservable and rentable facilities. It must be noted that a number of factors may influence the City's potential to generate these revenues. These factors include the City's capacity to promote availability and capture reservations, competition from other venues, seasonality, and the state of the overall local economy and people's willingness to engage these amenities.

Source	2014 (Actuals)	High Growth	% Incr	Moderate Growth	% Incr	No Growth	% Incr
River Shelter	\$ 8,871	\$ 26,113	194%	\$ 16,465	86%	\$ 11,225	27%
Forest Shelter	\$ 7,679	\$ 21,886	185%	\$ 13,800	80%	\$ 4,844	-37%
Splash Shelter	\$ 848	\$ 1,450	71%	\$ 1,080	27%	\$ 875	3%
Maintenance Barn Shelter	NA	\$ 26,113		\$ 16,465		\$ 11,225	
Stein-Boozier Barn	\$ 10,815	\$ 31,689	193%	\$ 19,601	81%	\$ 12,517	16%
Murase Plaza	\$ -						
Fields: Reduced Fee Youth	\$ 8,002	\$ 10,000	25%	\$ 9,000	12%	\$ 8,000	0%
Fields: Other	\$ 2,665	\$ 3,200	20%	\$ 3,000	13%	\$ 2,700	1%
Special Events	\$ 8,813	\$ 4,400	-50%	\$ 4,000	-55%	\$ 3,400	-61%
Community Gardens - raised bed	\$ 375	\$ 750	100%	\$ 750	100%	\$ 375	0%
Community Gardens - in-ground	\$ 2,178	\$ 2,640	21%	\$ 2,640	21%	\$ 2,178	0%
Watercraft Concessionaire	NA	\$ 4,500		\$ -		\$ -	
	\$ 50,244	\$ 132,740		\$ 86,801		\$ 57,339	

Figure 25 - REVENUE SCENARIOS BY FACILITY

Park Feature	Unit	Labor Hours per Year per Unit	No. Units	Labor Hours per Year	Labor-related Cost per Year	Materials & Services per Yr	Total Cost per Year
Labor-related costs							
Large turf areas	per acre	52.0	15.0	780.0	\$ 19,500	\$ 3,000	\$ 22,500
Small/medium turf areas	per acre	52.0	3.0	156.0	\$ 3,900	\$ 600	\$ 4,500
Shrub beds	per 1000sf	52.0	12.0	624.0	\$ 15,600	\$ 500	\$ 16,100
Flower beds	per 1000sf	28.0	2.0	52.0	\$ 1,300	\$ 250	\$ 1,550
Planted trees	per tree	13.0	12.0	156.0	\$ 3,900	\$ 1,000	\$ 4,900
Hard surfaces	per 1000sf	3.0	200.0	600.0	\$ 15,000	\$ 250	\$ 15,250
Soft-surface paths/lawns	per 1000sf	2.0	50.0	100.0	\$ 2,500	\$ 500	\$ 3,000
Turf multi-use fields	per field	52.0	3.0	156.0	\$ 3,900	\$ 3,000	\$ 6,900
Turf softball fields	per field	85.0	5.0	425.0	\$ 10,625	\$ 1,000	\$ 11,625
Irrigation system	per acre (irrigated)	10.0	28.0	280.0	\$ 7,000	\$ 8,000	\$ 15,000
Structures - clean/inspect/repair	per structure	36.0	5.0	175.0	\$ 4,375	\$ 250	\$ 4,625
Restrooms - clean & re-supply	per restroom	80.0	4.0	320.0	\$ 8,000	\$ 5,000	\$ 13,000
Play equipment - inspect & repair	per structure	48.0	2.0	96.0	\$ 2,400	\$ 1,000	\$ 3,400
Leaf removal	per acre (dev)	7.0	30.0	210.0	\$ 5,250	\$ 1,500	\$ 6,750
Storm debris	per acre (dev)	3.0	30.0	90.0	\$ 2,250	\$ 1,000	\$ 3,250
Security check & litter removal	per total acre	38.0	1.0	38.0	\$ 950	\$ 100	\$ 1,050
Empty trash cans	per can	30.0	30.0	900.0	\$ 22,500	\$ 1,000	\$ 23,500
Non-routine projects	per total acre	129.0	1.0	129.0	\$ 3,200	\$ 500	\$ 3,700
Totals				5286	\$ 131,700	\$ 154,900	\$ 286,600
Contracted costs							
Cost/Unit							
Water service	per acre (irrigated)	\$ 3,080	25.0		\$ 77,000	\$ 77,000	
Solid waste service	per bin	\$ 1,800	1.0		\$ 1,800	\$ 1,800	
Electricity service	per acre (dev)	\$ 1,400	25.0		\$ 35,000	\$ 35,000	
Porta-potty service	per each	\$ 900	5.0		\$ 4,500	\$ 4,500	
Contract repairs	per acre (dev)	\$ 250	1.0		\$ 250	\$ 250	
Landscape maintenance service	per acre (dev)	\$ 500	1.0		\$ 500	\$ 500	
Equipment rental	per acre (dev)	\$ 750	3.0		\$ 2,250	\$ 2,250	
Equipment repair & maintenance	per acre (dev)	\$ 1,000	5.0		\$ 5,000	\$ 5,000	
Totals							

Figure 26 - OPERATIONS AND MAINTENANCE EXPENSES BY FEATURE (2014)

Park Feature	Unit	Labor Hours per Year per Unit	No. Units	Labor Hours per Year	Labor-related Cost per Year	Materials & Services per Yr	Total Cost per Year
Labor-related costs							
Large turf areas	per acre	52.0	14.1	733.2	\$ 18,330	\$ 3,000	\$ 21,330
Small/medium turf areas	per acre	52.0	3.4	176.8	\$ 4,420	\$ 700	\$ 5,120
Shrub beds	per 1000sf	52.0	47.0	2444.0	\$ 61,100	\$ 1,500	\$ 62,600
Flower beds	per 1000sf	28.0	3.0	78.0	\$ 1,950	\$ 400	\$ 2,350
Planted trees	per tree	13.0	40.0	520.0	\$ 13,000	\$ 1,000	\$ 14,000
Hard surfaces	per 1000sf	3.0	362.7	1148.1	\$ 28,703	\$ 1,500	\$ 30,203
Soft-surface paths/lawns	per 1000sf	2.0	50.0	100.0	\$ 2,500	\$ 500	\$ 3,000
Turf multi-use fields	per field	52.0	1.0	52.0	\$ 1,300	\$ 2,500	\$ 3,800
Turf softball fields	per field	85.0	3.0	255.0	\$ 6,375	\$ 800	\$ 7,175
Synthetic turf fields	per field	42.0	3.0	126.0	\$ 3,150	\$ 800	\$ 3,950
Irrigation system	per acre (irrigated)	10.0	22.0	220.0	\$ 5,500	\$ 8,000	\$ 13,500
Structures - clean/inspect/repair	per structure	36.0	7.0	245.0	\$ 6,125	\$ 400	\$ 6,525
Restrooms - clean & re-supply	per restroom	80.0	6.0	480.0	\$ 12,000	\$ 7,500	\$ 19,500
Play equipment - inspect & repair	per structure	48.0	4.0	192.0	\$ 4,800	\$ 2,000	\$ 6,800
Leaf removal	per acre (dev)	7.0	36.0	245.0	\$ 6,125	\$ 1,500	\$ 7,625
Storm debris	per acre (dev)	3.0	39.0	105.0	\$ 2,625	\$ 1,000	\$ 3,625
Security check & litter removal	per total acre	38.0	1.0	36.0	\$ 900	\$ 100	\$ 1,000
Empty trash cans	per can	30.0	38.6	1098.0	\$ 27,000	\$ 1,000	\$ 28,000
Non-routine projects	per total acre	200.0	1.0	200.0	\$ 5,000	\$ 500	\$ 5,500
Contracted costs							
Cost/Unit							
Water service	per acre (irrigated)	\$ 3,080	22.0		\$ 67,760	\$ 67,760	
Solid waste service	per bin	\$ 1,800	2.0		\$ 3,600	\$ 3,600	
Electricity service	per acre (dev)	\$ 1,400	35.0		\$ 49,000	\$ 49,000	
Porta-potty service	per each	\$ 900	5.0		\$ 4,500	\$ 4,500	
Contract repairs	per acre (dev)	\$ 250	1.0		\$ 250	\$ 250	
Landscape maintenance service	per acre (dev)	\$ 500	1.0		\$ 500	\$ 500	
Equipment rental	per acre (dev)	\$ 700	6.0		\$ 4,200	\$ 4,200	
Equipment repair & maintenance	per acre (dev)	\$ 1,000	8.0		\$ 8,000	\$ 8,000	
Totals				8436	\$ 210,960	\$ 172,500	\$ 383,460

Figure 27 - OPERATIONS AND MAINTENANCE EXPENSES FOR MASTER PLAN

OPERATING EXPENSES

The annual operations and maintenance of Memorial Park are a significant on-going expense. The pace of future park improvements will be informed in part, by the likely operations impacts to the City budget. Figure 26 illustrates the current maintenance expenses for Memorial Park by major work area. The development of the preferred master plan will result in additional maintenance obligations for the City. The annual operating costs for the preferred master plan are estimated to be approximately \$383,000 (2015), approximately \$100,000 higher than the current maintenance costs. The largest impacts to the costs for the preferred master plan are due to increased quantities for hard surfaces. Figure 27 shows operation and maintenance expenses for the full build out of the Master Plan. As the City considers incremental or phased improvements to Memorial Park, the projected maintenance costs should be re-evaluated.

ADDITIONAL CONSIDERATIONS

Policy and marketing considerations may result in enhanced future revenue from construction of the preferred master plan. There is potential for the city to seek out and leverage partnerships to either help offset maintenance costs or conditionally expand facilities

In advance of implementing the preferred master plan, the City should consider reaching out specifically to user groups for three facilities: off-leash area, pump track and disc golf.

*Seek out advocates for off-leash areas to organized into non-profit (501C3) entities to create a vehicle for fund raising for off-leash area maintenance and acting as a source of volunteers to clean-up days or special fund raising events.

* For the pump track, seek to develop a volunteer base of cyclists for seasonal work parties, clean-ups and (re)construction activities.

* Similarly, the City can seek the support of local disc golf enthusiasts and clubs for assistance in laying out, installing and maintaining the disc golf course.

COSTS

Utilizing the proposed Master Plan, an estimate of Probable Costs was generated (figure 28). The estimate will be used by the parks department to aid in assessment of priority projects. Costs are broken down into categories and specific improvements, utilizing April 2015 industry standard costs.

Earthwork	
Site Demolition	\$128,000
Site Grading	\$691,000
Total	\$819,000
Parking and Trails	
NE Parking Lot	\$40,000
E Parking Lot	\$163,500
SW Parking Lot	\$145,000
Gravel Road at Watercraft Launch	\$22,500
Asphalt Trails	\$334,500
Soft Surface Trails	\$111,000
River Trail Overlooks	\$27,000
Boardwalk	\$100,000
Total	\$943,500
Sports Fields and Courts	
Synthetic Turf Ballfields #1, 2, incl. Movable Fences, Backstops, Dugouts, Goals	\$2,571,500
Natural Turf Ballfields #3,4,5, incl. Movable Fences, Backstops, Dugouts, Goals	\$517,000
Pickleball Courts, incl. Structure and Bleachers	\$542,000
Basketball Courts	\$89,000
Tennis Courts	\$250,000
Sand Volleyball Court	\$19,000
Total	\$3,988,500
Site Improvements	
Off-Leash Dog area	\$55,500
Skate Spot	\$192,000
Bike Pump Track	\$150,000
Community Garden	\$85,000
9 Hole Disc Golf Course	\$22,000
Playground at Court Sports Area	\$8,500
Nature Play Area	\$25,000
Amphitheater	\$177,500
Total	\$715,500
Buildings	
New Upper Maintenance Facility Building	\$285,000
Renovated Shelter with Restroom	\$334,000
Restroom at NE Parking Lot	\$82,000
Restroom at E Parking Lot	\$82,000
Restroom at Ballfields	\$172,000
Restroom and Concession at West Parking Lot	\$117,000
Concession at Ballfield	\$70,000
Total	\$1,142,000
Site Amenities	
Dock Launch	\$42,000
Misc. Site Furnishings	\$40,000
Planting and Irrigation	\$393,500
Utilities- Water, Sanitary, Storm	\$113,500
Utilities- Electrical incl. Ballfield Lighting	\$1,164,000
Total	\$1,753,000
Total	\$9,361,500
Estimated Contingency - 10%	\$936,000
General Conditions / Insurance / Bond - 10%	\$1,030,000
General Contractor OH & Profit - 4%	\$453,000
Total	\$11,780,500
The above estimates are for direct construction cost only. They do not include furnishings & equipment, architect and engineer design fees, consultant fees, inspection and testing fees, plan check fees, state sales tax, hazardous material testing and removal, financing costs, owners contingency, nor any other normally associated development costs.	

Figure 28 - ESTIMATE OF PROBABLE COST

PHASING

The following is a proposed phasing approach that assumes the proposed facility upgrades and new amenities will be developed in three separate phases. Figure 29 outlines the proposed phases and amenities included in each phase.

The phasing is proposed and should be re-evaluated as-needed based on Wilsonville’s evolving recreational needs, community desires and the city’s available funding.

Wilsonville Memorial Park Master Plan Estimate

Phase One	
Northeast Parking Lot	\$40,000
East Parking Lot	\$163,500
Relocation of Off-Leash Dog Park	\$55,500
Bicycle Pump Track	\$150,000
Restroom Facilities (Dog Park Area/Community Garden; East Parking Lot)	\$164,000
Community Garden Expansion & Improvements	\$85,000
9 Hole Disc Golf Course	\$22,000
River Trail Overlooks	\$27,000
Paths (Gravel Road at Watercraft Launch, Asphalt Trails, Soft Surface Trails, Boardwalk)	\$568,000
Sub-total for Phase One	\$1,275,000
Phase Two	
Southwest Parking Lot	\$145,000
Synthetic Turf Ballfields #1 & #2 (Incl. Movable Fences, Backstops, Dugouts, Goals)	\$2,571,500
Natural Turf Ballfields #3, #4, & #5 (Incl. Movable Fences, Backstops, Dugouts, Goals)	\$517,000
Skate Park	\$192,000
Unmotorized Watercraft Concession and Restroom	\$117,000
Food Concession Area	\$70,000
Fencing for Playground at Court Sports Area	\$8,500
Miscellaneous Site Furnishings	\$40,000
Landscape Irrigation & Planting Materials	\$393,500
Restroom Facilities at Ballfields	\$172,000
Sub-total of Existing Conditions (Site Demo)	\$128,000
Sub-total of Earthwork (Site Grading)	\$691,000
Sub-total of Utilities	\$1,277,500
Sub-total for Phase Two	\$6,323,000
Phase Three	
Courts (Basketball, Pickleball (Incl. Structure & Bleachers), Tennis, Sand Volleyball)	\$900,000
New Shelter & Restrooms at Lower Maintenance Barn	\$334,000
Amphitheater and Terraced Seating	\$177,500
New Upper Maintenance Facility	\$285,000
Nature Play Area	\$25,000
Dock Launch	\$42,000
Sub-total for Phase Three	\$1,763,500
Sub-total for Phases One Through Three	\$9,361,500
Estimating Contingency	\$936,000
General Conditions/Insurance/Bond	\$1,030,000
General Contractor OH & Profit	\$453,000
Sub-total	\$2,419,000
Total Direct Construction Cost	\$11,780,500

The above estimates are for direct construction cost only. They do not include furnishings & equipment, architect and engineer design fees, consultant fees, inspection and testing fees, plan check fees, state sales tax, hazardous material testing and removal, financing costs, owners contingency, nor any other normally associated development costs.

Figure 29 - PROPOSED PHASING



Figure 30 - MASTERPLAN

PAGE LEFT INTENTIONALLY BLANK

A faded, grayscale background image of a park. In the foreground, several people and dogs are scattered across a grassy field. Some people appear to be standing and talking, while others are walking. In the background, there is a dense line of trees. The overall scene is peaceful and suggests a community gathering or a dog park.

VII. APPENDIX

PUBLIC OPEN HOUSE 1 MEETING NOTES

Wilsonville City Hall, November 5th, 2014

- 1 No synthetic" turf upgrades requested at sports fields
- 2 Infield distance increase to 60' mound / 90' base to support adult softball leagues
- 3 No adult specific ball fields available in Wilsonville? People go elsewhere
- 4 Lighting is a safety issue throughout park
- 5 Flat NE meadows area becomes inundated in winter/spring, undevelopable?
- 6 Some concerns expressed about quantity of parking available if community garden is expanded
- 7 Community garden could be moved elsewhere to accommodate additional use, or used as a buffer itself around parking on East side
- 8 Skate park is well used despite its small size and lack of features. Should be enlarged.
- 9 A large skate park project is planned elsewhere in Wilsonville
- 10 A trail system/trailhead layout was suggested, consisting of 3 trail lengths which would be color coded for easy recognition, i.e.: green 3/4mi, blue 1.5mi, red 3mi loops
- 11 A trailhead/kiosk providing trail information route length etc is needed
- 12 Waterfountains are needed throughout, nowhere to fill up your water bottle, difficult to fill bottles at existing fountains
- 13 Re-vegetating informal trails in Riverfront area may not be beneficial since kids still ride their bikes there regardless, moving tree limbs or riding over them
- 14 Residents do not want increased development on the East side
- 15 Not much concern was expressed for a pedestrian connection from Murase plaza to the East side
- 16 Pickle ball tournaments can attract 75-100 people, along with concessions etc, (USAPA.com)
- 17 Residents enjoy walking in the dog park and East side because of natural areas
- 18 Walking through the river front area at night can be "sketchy"
- 19 Benches are needed throughout the entire park, additional seating needed at water feature area during high use
- 20 Bus access needed into site. Park is large for only 1 planned stop
- 21 Basketball is used a lot
- 22 Trail lighting is needed
- 23 Loop road concerns originated from kids racing around it, thus its original removal
- 24 The trail from Murase plaza to lower park is steep and not ADA compliant
- 25 Guided history trips could be a use for the water trail. Park could be a stop along the way
- 26 At the West parking area the vehicular gate blocks pedestrian walkway
- 27 The amount of bicycle use on un-paved paths is not currently an issue
- 28 The playground located at west area near fields could be doubled in size, heavily used to ease of access and adjacency to parking
- 29 Pickle ball in barn - ?
- 30 A rhododendron or wetland garden were suggested
- 31 Passive uses suggested for the East side
- 32 More trails in the East side suggested
- 33 A route to the dock would be beneficial
- 34 It was suggested that there is no need to reconnect the loop road
- 35 Loop trail in the wood suggested
- 36 All fields need new lighting
- 37 All fields need better drainage
- 38 There could be a small concert stage on the East side
- 39 Interest in having concessions for tournaments
- 40 Could the pump station go in the old Nike wellhouse?
- 41 Turf fields (infields?) suggested

- 42 Possible restroom by forest shelter suggested
- 43 Users would like to see more pickle ball courts

PUBLIC OPEN HOUSE 2 MEETING NOTES

Wilsonville City Hall, December 16th, 2014

- 1 An overview of the Wilsonville park system would help the public understand and validate proposed program and enhancements
- 2 Covered pickleball courts would enhance play and increase seasonal usability
- 3 Easier kayak launching would be beneficial
- 4 The river is not an attractive swimming destination
- 5 Trees should not be cleared in order to create a waterfront
- 6 The existing maintenance barn could serve well as a shelter supporting events such as dances and arts and crafts events for kids
- 7 Tournament field configuration (option 3) is too large and does not cater to the primary users who live in Wilsonville
- 8 Road adjacent to the river shelter could be improved to provide waterfront access
- 9 There are safety concerns crossing Wilsonville Rd and Memorial Dr to access Murase Plaza
- 10 There is a need for more buffer at existing parking areas (West?)
- 11 There should only be passive uses on the East side
- 12 25% min. more community gardens are needed
- 13 Option 2 West side could be blended with Option 1 East side
- 14 Pickle Ball additions on Option 1 work well
- 15 Bus and RV turning space is potentially needed
- 16 Positive responses received for Option 3 amphitheater
- 17 Zip lines could be considered
- 18 There is a drainage issue at the River Shelter

- 19 Positive response to overlooks – tree removal could be minimized
- 20 Option combinations – OPT 3 North / OPT 2 West / OPT 2 East / OPT 1 River
- 21 More benches should be provided
- 22 Existing dock needs modification for easier access
- 23 Storage could be provided for light watercraft near existing dock
- 24 Basketball can be kept in place
- 25 Concerns that the skate park is too remote
- 26 Concerns about concessions and revenue
- 27 The intertwining trails in the forest are good
- 28 ‘Movies in Parks’ need open space for viewing – currently use sloping lawn
- 29 A backboard for tennis would enhance the court for individual practice
- 30 Normal high water is above the boat ramp and makes current access to existing dock difficult during portions of winter time
- 31 East buffer is important
- 32 Available space is not enough to create regional draws
- 33 Park should be geared towards existing resident’s preferred uses
- 34 There should not be any parking off Rose Ln
- 35 Large Girl Scout groups prefer parking options 1 and 2 for forest access
- 36 Schools, boy and girl scout groups would use a developed amphitheater
- 37 Girl Scouts use variety of trails, would prefer a trail connection between River and Forest Shelters
- 38 Privacy of River Shelter space before trees to west were removed is preferred
- 39 Some form of buffer between Forest Shelter and fields is preferred for noise mitigation
- 40 One main paved path through the Forest and the rest un-paved would be preferred
- 41 River overlooks could be historically thematic or otherwise to provide diverse experiences
- 42 More buffer needed on West edge

- 43 Turf infields would be very beneficial
- 44 Current dog park size is sufficient
- 45 The “waterfall” and water wheel have not been mentioned, could be destinations
- 46 Bicycle skills course and skate park could be adjacent
- 47 Overlooks work well but waterfront beach is not necessary

- 16 Existing field 5 is for kids and girls softball with an outfield need of 225’ and 60’&70’ base paths
- 17 Single tees better than multiple tees for disc golf. Single tees often allow for difficult pin placements.
- 18 Disc golf course as shown would be targeted as a family friendly course
- 19 Disc Golf: High school aged throw 200’-275’, pro’s throw 350’-400’
- 20 9 hole disc golf preferred over 6 long holes.
- 21 Synthetic fields a good idea.
- 22 Provide area at pickleball courts for a paddle que.
- 23 Provide lighting at pickleball canopy and full concessions with electricity at concession area near pickleball.
- 24 Provide small building for ballfield maintenance equipment.
- 25 One citizen expressed no concerns about running or walking through disc golf area when course is actively being used. Others expressed safety concern of being near disc golf.
- 26 Provide at least 1 ada trail to overlook.
- 27 Park needs year around drinking fountains.
- 28 Bicycle pump track is a good idea and will provide kids an alternative method of recreation

PUBLIC OPEN HOUSE 3 MEETING NOTES

Wilsonville City Hall, February 18, 2015

- 1 Existing dock is overloaded currently. Could be conflicts with light watercraft, motorized watercraft and dock users.
- 2 Maintain Motorized Boat access to dock.
- 3 Provide places for kids to connect to river.
- 4 Existing grade to dock is too steep.
- 5 Light watercraft access at current dock will be difficult due to narrow gangway
- 6 Section of Willamette along Memorial Park is better to waterski in than kayak due to motorized traffic
- 7 Light watercraft should utilize Boones Ferry Park.
- 8 Regional Trail West option was preferred. Comments such as better connection to town center, more gradual climb were noted.
- 9 Both regional trails should be major trails in the park.
- 10 Additional trees for shade were requested for Murase plaza.
- 11 City needs more dog parks.
- 12 Put money into other parks first.
- 13 Provide services for citizens of Wilsonville, not people from the region.
- 14 Retain more trails in forest along the river.
- 15 Park needs more trash cans.

**STAKEHOLDER MEETING NOTES:
WILSONVILLE HIGH SCHOOL**

Wilsonville Parks and Rec. Dept., October 17th 2014

- 1 What events does WHS use Memorial Park for?
Cross country meet- 1 per year- 1 shelter as hospitality area, like to take over park, but work with leagues. 5000 meter course. Prefer non-paved areas. Fall.
Tennis- recent past, lower level softball games.
Baseball- no 90' diamond (would increase partnership with youth program)- springtime march-June
- 2 What times? Time of year, time of day/night, duration of use?
- 3 Are there conflicts with other park uses? coordination between leagues (overlapping calendars, multi-use fields, seasonality, etc)
Buses park off-site, turnaround at gravel lots
Work with Willamette united / proper communication limits conflicts.
- 4 Are the facilities sufficient, field sizes/quantity, parking/access, restrooms, concessions?
No real issues with facilities
- 5 Are there issues with the park that restrict your uses, ie would you do other uses if the facility allowed (field size, etc)?
- 6 Buses?
- 7 Are there other parks you use for events / uses?
- 8 Are there opportunities for more collaborative projects between school and city?
Tournaments and coaches involved- could be collaborative
Lacrosse tournaments, soccer tournaments- host different age groups, but could expand with memorial park
- 9 Do you have any concerns about scheduling, maintenance, or working with Parks Dept. on the fields they manage?
- 10 What roles do concessions play or could play in financial support of the league?

Would be encouraged, help pay for reduced cost of admissions for teams, etc.

Existing ones at high school- booster club ran.

11

What is the potential for tournaments? What are the needs to make one successful (# and location of fields)

2-3 day tournaments

Soccer 55-75yards wide- look up high school field sizes.

Trends- soccer, lacrosse up. Basketball up, girls numbers have dropped, baseball dropped a bit.

**STAKEHOLDER MEETING NOTES:
WILLAMETTE UNITED SOCCER CLUB**

Wilsonville Parks and Rec. Dept., October 17th 2014

- 1 What events does WUSC use Memorial Park for?
Soccer
\$1 million / year budget. Break even with 3 employees
Use all fields every day.
- 2 How many leagues, teams?
1800 kids K-12 recreational
500 competitive year around
All from WWLSD
220 kids co-ed high school teams
- 3 What times? Time of year, time of day/night, duration of use?
Beginning of August – Mid November.
August tournaments
Would like to use in the spring, but fields too wet.
- 4 Are there conflicts with other park uses? Coordination between leagues (overlapping calendars, multi-use fields, seasonality, etc.)
Seem to work out scheduling conflicts. Would like to have separate soccer fields.
- 5 Are the facilities sufficient, field sizes/quantity, parking/access, restrooms, and concessions?
Parking can be difficult at times. Lots of people park at dog park area and conflicts happen. Hard to manage.
Restrooms are adequate w/ porta potties.
- 6 Are there issues with the park that restrict your uses, ie would you do other uses if the facility allowed (field size, etc)?
Can't use in Springtime as fields are too wet.
Would like to see Turf on several fields.
- 7 Are there other parks you use for events / uses?
Year around use Artificial Turf fields, Horizon Christian, etc.
- 8 What has been the trend in participation by league / sport?
Participation numbers have held steady. Slight drop with other sports becoming more popular, i.e. lacrosse, etc.
- 9 Do you have any concerns about scheduling, maintenance, or working with Parks Dept. on the fields they manage?
Some irrigation boxes at SW corner of fields is in field of play sometimes.
A few wet spots on West side of fields.
- 10 What roles do concessions play or could play in financial support of the league?
Would help. They have concessions at other locations and while it is not a huge moneymaker, it does help.
- 11 What is the potential for tournaments? What are the needs to make one successful (# and location of fields)

**STAKEHOLDER MEETING NOTES:
NW DIAMOND SPORTS**

Wilsonville Parks and Rec. Dept., October 17th 2014

1 What events does NWDS use Memorial Park for?

Baseball/softball
11-18 year olds

2 What times? Time of year, time of day/night, duration of use?

May-Oct.

Would go year around if fields were not so wet, or if Turf fields.

3 Are there conflicts with other park uses? coordination between leagues (overlapping calendars, multi-use fields, seasonality, etc.)

Worried about security near Forest Shelter

4 Are the facilities sufficient, field sizes/quantity, parking/access, restrooms, concessions?

Field sizes are adequate.

Infields could be enlarged a bit to provide more flexibility of age groups and would allow for more efficient use of fields. Currently uses 70',80',90' bases. Infields 1 and 2 are not large enough for all base options.

Larger infields and outfields would allow for more efficient use of fields potentially creating additional time slots for other leagues.

Outfields , 10-12 year olds min 200' max 220', 13-18 min. 300' max 400', Softball 300' fences.

Does not use field 5, does not see it used.

Would like to see a registration area for camps / clinics / large events.

Would like covered dugouts

5 Are there other parks you use for events / uses?

Surrounding schools for Turf during wet weather. Horizon Christian, etc.

6 Do you have any concerns about scheduling, maintenance, or working with Parks Dept. on the fields they manage?

Would like to be able to water down in-fields when needed- if they could push a button or something like that.

Some of the outfields could use leveling at times.

7 What roles do concessions play or could play in financial support of the league?

Would love to have gas hookup for bbq's, but not a major deal.

Would help for tournaments.

8 What is the potential for tournaments? What are the needs to make one successful (# and location of fields)

If fields were turf, they would use them for tournaments.

3 fields for small tournament, 5 for large tournament.

**STAKEHOLDER MEETING NOTES:
WILSONVILLE PICKLEBALL CLUB**

Wilsonville Parks and Rec. Dept., October 17th 2014

- 1 How many leagues, teams?
Not a club yet, no funding currently.
Socializing event, big with adults over 50•
- 2 What times? Time of year, time of day/night, duration of use?
Year around, rain or shine
Event every two weeks currently. Bring in portable nets and use tennis courts.
6 things going on per week currently. Player development and teaching.
- 3 Are there conflicts with other park uses? Coordination between leagues (overlapping calendars, multi-use fields, seasonality, etc.)
- 4 Are the facilities sufficient, field sizes/quantity, parking/access, restrooms, and concessions?
Would like to have covered courts to provide shade and rain protection.
4 courts would be great, with ability to incrementally add 4 additional at a time.
Lighting on courts to allow night time play would quadruple usage.
- 5 Are there other parks you use for events / uses?
Tualatin Community park has Sunday tennis and pickleball
- 6 What has been the trend in participation by league / sport?
Usage is becoming very popular
More courts would draw more users.
- 7 Are there opportunities for more collaborative projects between league and city?
- 8 What is the potential for tournaments? What are the needs to make one successful (# and location of courts)
Ideally 15 courts for tournaments
Potential for 2 large annual tournaments.
Thursday-Saturday

**STAKEHOLDER MEETING NOTES:
WILSONVILLE WALKERS**

Wilsonville Parks and Rec. Dept., October 17th 2014

- 1 How does WW use the park?
30-40 members walk the park Tuesday and Thursday.
2 mile walking loops typically.
- 2 What times? Time of year, time of day/night, duration of use?
All year long, rain or shine.
Usually during the morning.
- 3 Are the facilities sufficient, field sizes/quantity, parking/access, restrooms, and concessions?
Like new parking lot.
Would like to have different waling loops with different difficulties.
Trails are maintained good.
Were very interested in interp. panels providing entertainment for walks.
- 4 Is the wayfinding sufficient?
Lots of trails can be confusing. Tend to stay on road and open trails due to safety, familiarity access. Lots of older members who can't do hills.

STAKEHOLDER MEETING NOTES: ADULT SOCCER CLUB

Wilsonville Parks and Rec. Dept., October 17th 2014

- 1 What events does the ASC use Memorial Park for?
Soccer
Sundays, 8am-3pm. May – October.
- 2 How many leagues, teams?
4-5 teams, 2 fields.
15 per team and family members. Mainly Hispanic league, but seeing a lot of white spectators
- 3 What times? Time of year, time of day/night, duration of use?
Sundays
Don't do rainy days
- 4 Are the facilities sufficient, field sizes/quantity, parking/access, restrooms, and concessions?
Restroom facilities are lacking, especially for women.
Ok with designated parking near maintenance. Try to not park at dog park area.
Some irrigation boxes at SW corner of fields is in field of play sometimes.
- 5 Do you have any concerns about scheduling, maintenance, or working with Parks Dept. on the fields they manage?
Don't play in wet conditions because they don't want to destroy the fields.
Paint their own field.
- 6 What roles do concessions play or could play in financial support of the league?
No role. Bring own food.

STAKEHOLDER MEETINGS NOTES: GIRLS SCOUTS OF OREGON AND SW WASHINGTON

Wilsonville Parks and Rec. Dept., October 17th 2014

- 1 How do GS use the park?
23 years. One week / year day camp in last week of June.
400 girls, 5-18 years old. # is sufficient.
Use both shelters, and like that they are "easy access"
Hiking trails, archery area
"Most people don't know they are there. Like the isolation of the shelters.
- 2 Are the facilities sufficient, quantity, parking/access, restrooms?
Have to have someone manage parking.
Could be marked better
Have 2 large busses and turning around is hard.
Concerns about development to the west, access from the new homes, and removal of trees changed the character of the River Shelter.
Cannot go to the water as river bank is too steep.
Bring their own camp, food, restrooms. Set up at 7:30am, out by 4:30pm every day.
- 3 Are very concerned about safety, police access, fire access.
- 4 "Keep nooks" along paths. They need space to gather
Desire a climbing wall
An areas sized for a picnic shelter "can be anywhere"
- 5 Boy Scouts use the Park. Chris Troha- HS teacher at WVHS and John Budais and scout masters.
- 6 Girl Scouts have 1 volunteer day at Memorial Park per year. Available to do more.

PAGE LEFT INTENTIONALLY BLANK

Q1 What is your gender?

Answered: 617 Skipped: 0

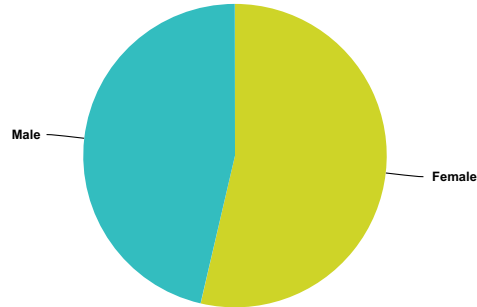

Answer Choices	Responses	
Female	53.65%	331
Male	46.35%	286
Total		617

Q2 What is your age?

Answered: 617 Skipped: 0

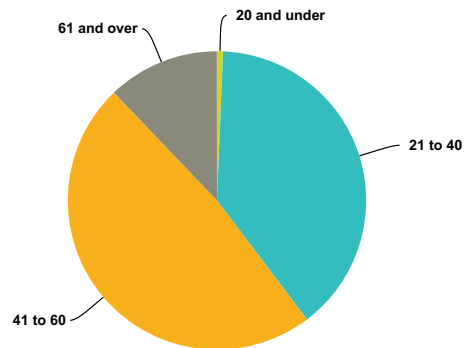

Answer Choices	Responses	
20 and under	0.65%	4
21 to 40	39.06%	241
41 to 60	48.14%	297
61 and over	12.16%	75
Total		617

Q3 If any, what are the ages of the children in your household?

Answered: 617 Skipped: 0

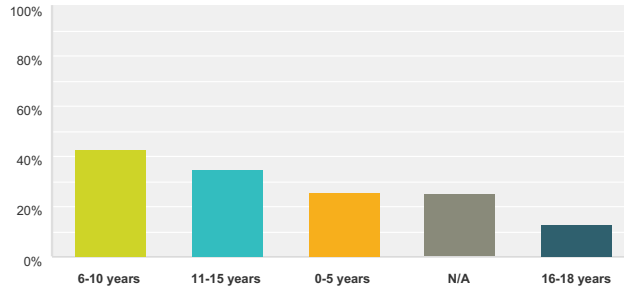

Answer Choices	Responses	Count
6-10 years	42.63%	263
11-15 years	34.68%	214
0-5 years	25.45%	157
N/A	25.12%	155
16-18 years	12.80%	79
Total Respondents: 617		

Q4 How often do you use Memorial Park?

Answered: 592 Skipped: 25

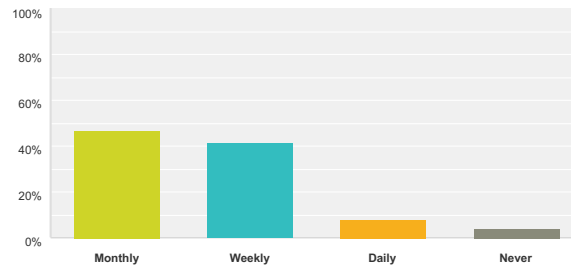

Answer Choices	Responses	Count
Monthly	46.79%	277
Weekly	41.22%	244
Daily	7.77%	46
Never	4.22%	25
Total		592

Q6 Where do you live in relation to Memorial Park?

Answered: 592 Skipped: 25

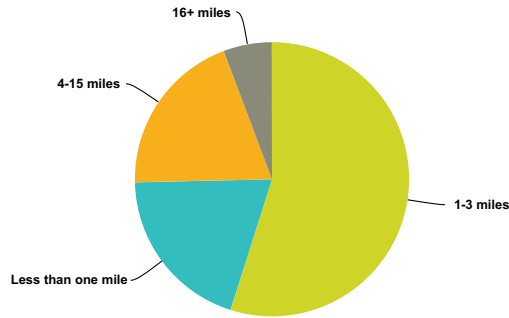

Answer Choices	Responses	Count
1-3 miles	54.90%	325
Less than one mile	19.76%	117
4-15 miles	19.59%	116
16+ miles	5.74%	34
Total		592

Q7 When you visit the park, how do you arrive?

Answered: 585 Skipped: 32

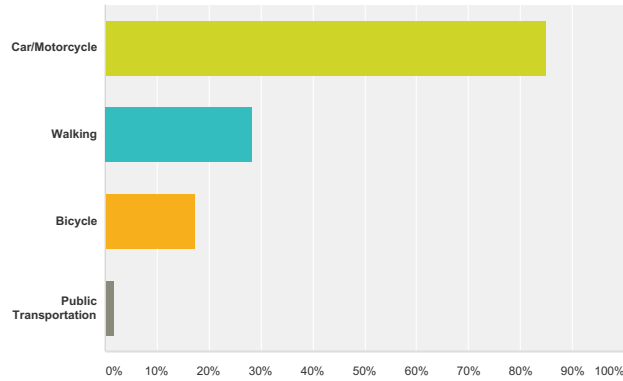

Answer Choices	Responses	Count
Car/Motorcycle	84.96%	497
Walking	28.38%	166
Bicycle	17.26%	101
Public Transportation	1.71%	10
Total Respondents: 585		

#	Other (please specify)	Date
1	Running	1/8/2015 8:29 AM
2	Space ship	1/8/2015 4:14 AM
3	stroller	12/26/2014 3:44 PM
4	Jogging	12/25/2014 3:56 PM
5	running	12/22/2014 3:48 PM
6	skateboard	12/19/2014 12:43 PM
7	Youth Sports	12/19/2014 12:41 PM
8	Do not use the park to many parks in Wilsonville already	12/19/2014 9:02 AM
9	Dont use	12/19/2014 8:13 AM
10	Don't	12/17/2014 5:02 PM
11	Hiking and jogging	12/16/2014 4:14 PM

Q10 If investments were made to existing athletic fields and/or new fields were incorporated, would you prefer:

Answered: 574 Skipped: 43

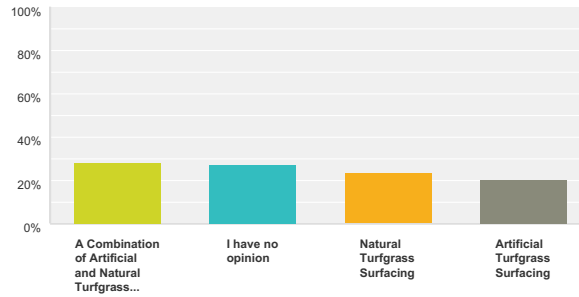

Answer Choices	Responses	
A Combination of Artificial and Natural Turfgrass Surfacing	28.40%	163
I have no opinion	27.70%	159
Natural Turfgrass Surfacing	23.34%	134
Artificial Turfgrass Surfacing	20.56%	118
Total		574

Q5 What days and times do you most use the park?

Answered: 592 Skipped: 25

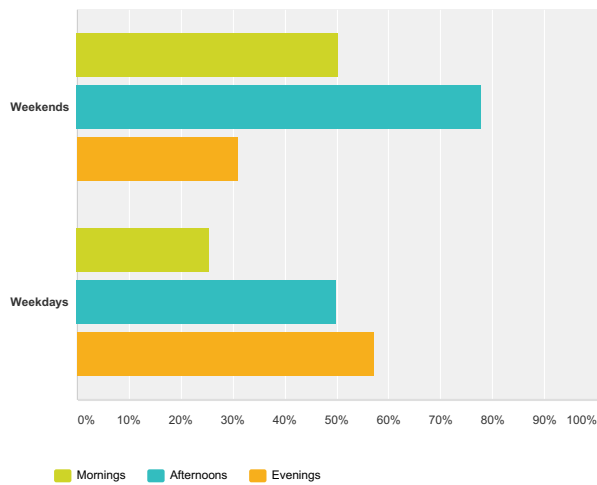

	Mornings	Afternoons	Evenings	Total Respondents
Weekends	50.30% 254	77.82% 393	30.89% 156	505
Weekdays	25.56% 125	49.90% 244	57.26% 280	489

Q8 Which (5) activities/resources do you most utilize when at Memorial Park?

Answered: 579 Skipped: 38

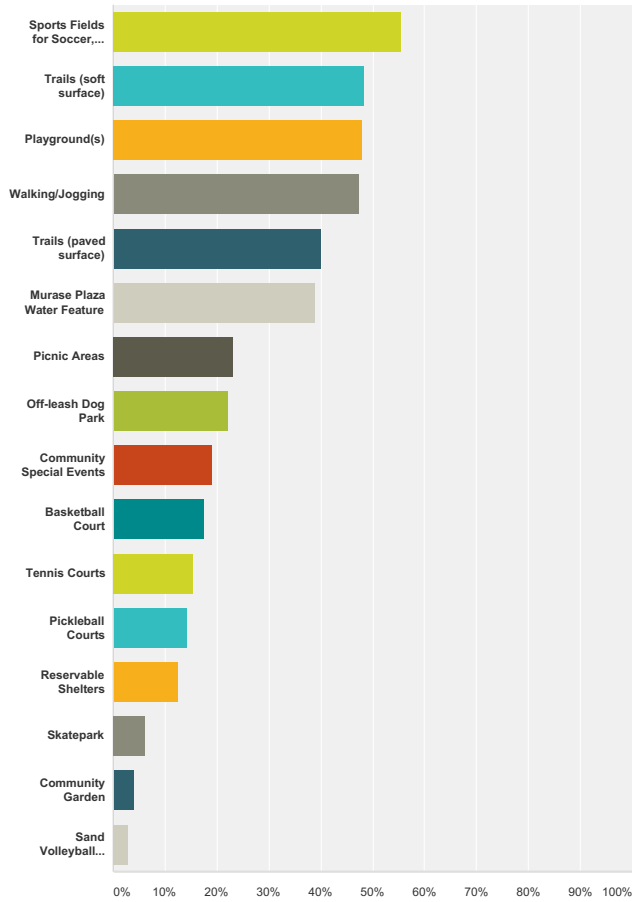

Answer Choices	Responses
----------------	-----------

Sports Fields for Soccer, Baseball, or Softball	55.44%	321
Trails (soft surface)	48.53%	281
Playground(s)	48.01%	278
Walking/Jogging	47.32%	274
Trails (paved surface)	40.07%	232
Murase Plaza Water Feature	38.86%	225
Picnic Areas	23.14%	134
Off-leash Dog Park	22.11%	128
Community Special Events	19.00%	110
Basketball Court	17.44%	101
Tennis Courts	15.54%	90
Pickleball Courts	14.16%	82
Reservable Shelters	12.44%	72
Skatepark	6.22%	36
Community Garden	3.97%	23
Sand Volleyball Court	2.94%	17
Total Respondents: 579		

#	Other (please specify)	Date
1	Sports Fields to throw discs (disc golf driving practice)	1/16/2015 2:28 PM
2	RC cars, airplanes	1/4/2015 12:43 PM
3	disc golf	1/2/2015 9:46 AM
4	the dock	12/30/2014 8:54 PM
5	river view, wildlife viewing	12/26/2014 10:52 PM
6	Birding	12/19/2014 2:40 PM
7	dock	12/19/2014 12:44 PM
8	Natural areas	12/19/2014 10:48 AM
9	Do not use any of these services never go to Memorial Park	12/19/2014 9:03 AM
10	None	12/19/2014 8:13 AM
11	River Access	12/17/2014 8:15 PM
12	none	12/17/2014 5:02 PM
13	open space	12/16/2014 7:43 PM
14	walking dog on leash	12/15/2014 4:31 PM
15	how about Disc Golf ???	12/15/2014 10:57 AM
16	natural areas since you planted the meadow in trees not a lot of that left	12/15/2014 10:49 AM

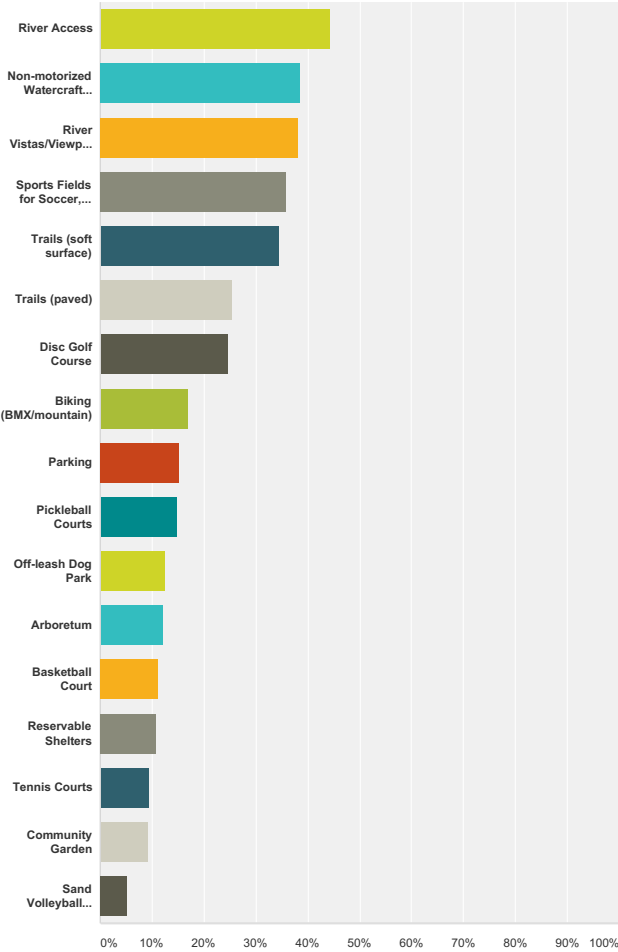

Answer Choices	Responses
River Access	44.18% 243
Non-motorized Watercraft (kayaks, canoes, paddleboards, etc.)	38.55% 212

River Vistas/Viewpoints	38.18%	210
Sports Fields for Soccer, Baseball, or Softball	36.00%	198
Trails (soft surface)	34.55%	190
Trails (paved)	25.45%	140
Disc Golf Course	24.73%	136
Biking (BMX/mountain)	16.91%	93
Parking	15.27%	84
Pickleball Courts	14.91%	82
Off-leash Dog Park	12.55%	69
Arboretum	12.18%	67
Basketball Court	11.27%	62
Reservable Shelters	10.91%	60
Tennis Courts	9.45%	52
Community Garden	9.09%	50
Sand Volleyball Court	5.27%	29
Total Respondents: 550		

#	Other (please specify)	Date
1	more running/walking paths	1/16/2015 4:40 PM
2	like movies in the park and would like to see other art events here. Gets crowded trying to get out however	1/14/2015 9:51 PM
3	dont need much more - leave the open space unimproved as they currently are	1/14/2015 2:11 PM
4	more protection of natural areas, less tree cutting	1/11/2015 3:01 PM
5	Concession stands for events to be run by non-profits, turf fields	1/9/2015 10:12 PM
6	Concession stand for baseball	1/9/2015 8:38 PM
7	Work on the improving the Wood fields or adding to Lowrie and leave Memorial as is	1/9/2015 6:12 PM
8	Closer bathrooms and water facilities to all sports fields.	1/9/2015 5:59 PM
9	Creation of a batting facility with concessions for Wilsonville youth softball and baseball programs	1/9/2015 4:23 PM
10	Playground	1/9/2015 9:19 AM
11	bigger skate/bike park	1/8/2015 5:47 PM
12	Skatepark	1/8/2015 4:51 PM
13	Covered pickleball	1/8/2015 7:40 AM
14	P	1/8/2015 4:24 AM
15	Turf baseball fields, mountain bike trail system	1/7/2015 10:54 PM
16	Lights for baseball field that is not lighted currently.	1/7/2015 10:35 PM
17	Snack Stand for Kids sports	1/7/2015 7:00 PM
18	Skateboarding	1/7/2015 5:56 PM

Q10 If investments were made to existing athletic fields and/or new fields were incorporated, would you prefer:

Answered: 574 Skipped: 43

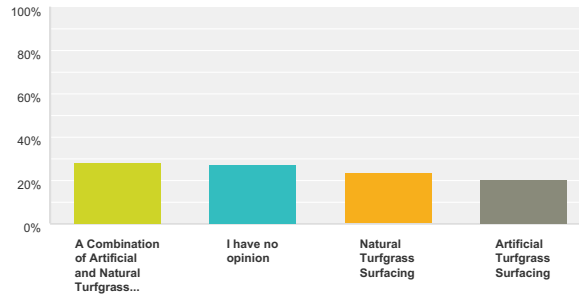

Answer Choices	Responses
A Combination of Artificial and Natural Turfgrass Surfacing	28.40% 163
I have no opinion	27.70% 159
Natural Turfgrass Surfacing	23.34% 134
Artificial Turfgrass Surfacing	20.56% 118
Total	574

PAGE LEFT INTENTIONALLY BLANK

PROJECT NUMBER: # 14-061PLN ISSUE DATE: May 3, 2015 (revised: 07/15/15)
PROJECT NAME: City of Wilsonville Memorial Park Master Plan

TO: Steve Duh
FROM: Ian Holzworth, Walker Macy

SUBJECT: Park Revenue Scenarios & Potential Operations Expenses

This memorandum addresses the existing revenues and potential revenue scenarios for the preferred master plan for Memorial Park. It also addresses existing and potential operating expenses for the park. It concludes with policy and marketing considerations that may result in enhanced future revenue from construction of the preferred master plan.

Master Plan Amenities Affecting Revenues

The preferred master plan for Memorial Park adds new infrastructure and amenities that balance the community's interest in expanded recreation opportunities within the context of the physical constraints of the park. While numerous amenities are proposed in the master plan, this memo focuses on those that will facilitate revenue generation for the City and include the following:

- Shelter rental - facility rental fees
- Community gardens - plot fees
- Amphitheater/stage - opportunity for events
- Pickleball - opportunity for small tournaments
- Pump track - opportunity for events or competitions
- Disc golf course - opportunity for small tournaments
- Water-based concessionaire (i.e., kayak, canoe) - seasonal concession fees

Park Revenues

City staff provided 2014 revenue data for the revenue-generating amenities of Memorial Park. The various amenities at the park generated approximately \$50,000, and the details by facility are itemized in Table 1.

Table 1: Revenue by Amenity (2014)

Amenity	2014 (Actuals)
River Shelter	\$ 8,871
Forest Shelter	\$ 7,679
Splash Shelter	\$ 848
Stein-Boozier Barn	\$ 10,815
Murase Plaza	\$ -
Fields: Reduced Fee Youth	\$ 8,002
Fields: Other	\$ 2,665
Special Events	\$ 8,813
Community Gardens - raised bed	\$ 375
Community Gardens - in-ground	\$ 2,178
	\$ 50,244

In estimating the future potential revenue scenarios for the park, assumptions were established based on historic rental information, utilization and capacity.

Assumptions regarding Utilization

The City of Wilsonville's facility reservation and event fee schedules split charges by resident and non-resident status and include pricing for midweek and weekend periods. Upon review of the 2014 revenue data, estimates for the resident and non-resident percentage splits by facility were established for use in estimating future revenue potential.

Additionally, a more detailed review of available capacity was completed to compare reservation histories of the two shelters and the barn for 2013 and 2014 with the annual calendar. Although the City only charges fees for the shelters between the 2nd weekend in April and the 2nd weekend in October, a review of the full-year calendar offers a more complete picture of the latent capacity for these facilities. Tables 2 and 3 illustrate the number of usage (reservation) days by period for each facility. Peak season is defined as May through October, and off-peak is November through April, and the total number of available days by use period were calculated separately for each year.

Table 2: Shelter and Barn Facility Rentals & Latent Capacity by Use Period (2013)

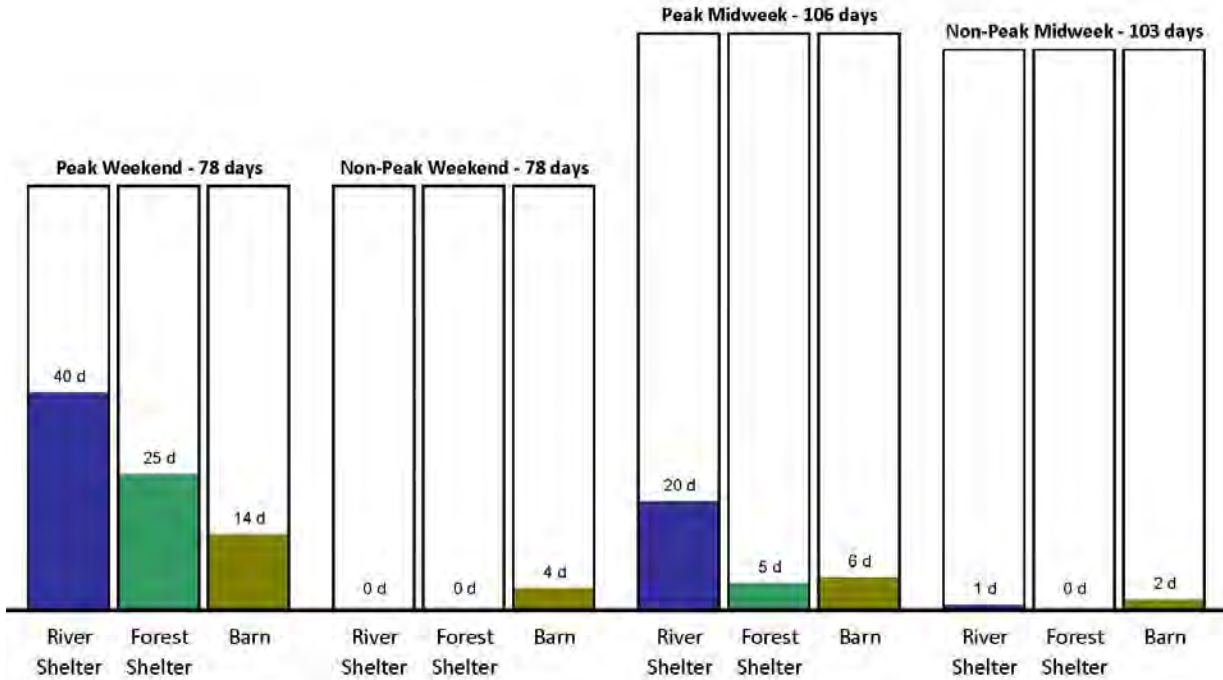
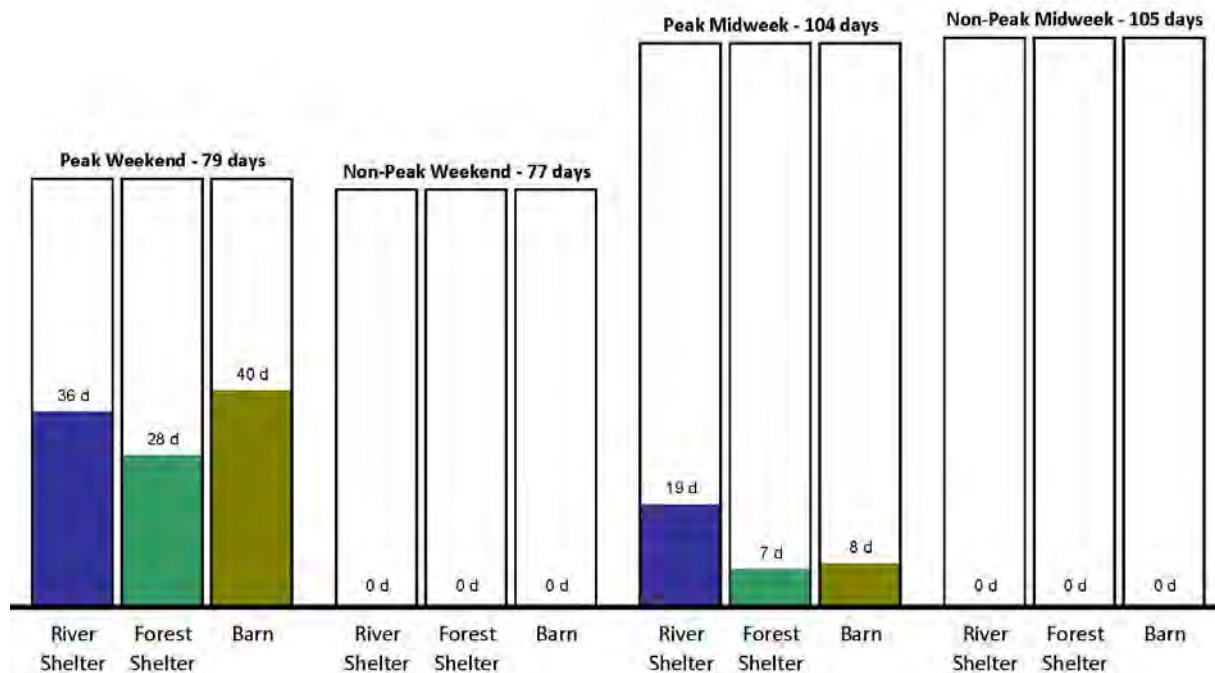

Table 3: Shelter and Barn Facility Rentals & Latent Capacity by Use Period (2014)



Significant unutilized capacity existed with these three facilities during the past two years; however, barn rentals were greatly improved in 2014 over the previous year. To estimate rental revenues for these facilities, utilization benchmarks were assumed for the different revenue scenarios. A high-growth scenario assumed rental reservations for 80% of the available peak period days, with a 75%/25% resident to non-resident split for shelters and 65%/35% split for the Stein-Boozier Barn. The resident percentage splits were based on recent annual averages.

Assumptions by Amenity

Usage and revenue potential was also considered based on the new amenities illustrated in the preferred master plan for the park and are discussed below.

- Community gardens: The reconfigured layout for the community gardens is approximately 0.6 acres. Using that estimate and the City's current sizing for in-ground and raised beds, the new garden configuration could accommodate approximately 15 new raised beds and 20 new in-ground (net additional). This would generate a net increase in garden fees (at current fees) of approximately \$800-\$1,000 per year.
- Picnic shelter: The proposed conversion of the maintenance barn into a third reservable picnic shelter will enhance the revenue potential for the park. It is assumed that the fee structure for this new shelter would be aligned with that of the River Shelter.
- Amphitheater with stage: Additional fees from special event permits are assumed; however, new revenue from additional events may be limited due to the existing number of programmed events on the City calendar. For the purpose of the revenue modeling, it was assumed that an additional 4-5 new events could be scheduled that trigger the requirements of the City's Special Use Permit. These events could generate upwards of \$1,000 annually in new revenues. The scheduling and usage of the amphitheater would need to be balanced with general park use and the existing suite of events.
- Pump track: As a small and growing activity, cycling on a pump track can create an opportunity for demonstration events and/or competitions. In the initial years, it may be reasonable to host 1 to 2 such events per year; however, the number of participants will likely fall below the 250 person minimum to trigger the Special Use Permit. Therefore, assigning a revenue potential for this amenity is not feasible at this time.
- Disc golf course: The nine-hole, multi-pitch course could provide an opportunity for small tournaments or demonstration events. However, the size and complexity of the course likely would not create a regional draw for large events or tournaments. It is unlikely that any event planned for this amenity would trigger the 250 person minimum for a Special Use Permit; therefore, assigning potential revenue to this amenity is not feasible at this time.
- Pickleball: The planned addition of pickleball courts may create an opportunity for small tournaments. Such tournaments can be sanctioned through the USAPA, but they do not need to be. Depending on the local enthusiasm for pickleball, a small tournament may fall below the 250 person event threshold to trigger the Special Use Permit. For revenue modeling, it was assumed that dedicated pickleball court time could be charged on a per hour basis, much like the reservation system for sport fields.

- Water-based concessionaire: A seasonal vendor could be accommodated at the proposed, extended southern parking lot. A specialized user agreement or concessionaire/vendor agreement would need to be crafted to accommodate this new activity/use, especially given the need for the City to manage potential risk and liability concerns. For revenue modeling, it was assumed that concession fees would be established as a flat annual fee to the concessionaire, plus a percentage of sales.
- Sport Fields: In comparing the preferred master plan layout to other regionally significant sport complexes (Delta Park, Sunset Park Sports Complex, Terpenning Recreation Complex and Salem's Wallace Marine), the new layout will provide added potential for non-local tournament play, and the installation of synthetic turf fields will maximize usage and improve revenue recovery. However, the number of fields, lighting and parking may continue to be limiting factors. In assessing the revenue potential for the park, the presumed scenario is that this mix of fields will be utilized for local and metro area tournaments. The complex may not be large enough to generate increased utilization of local hotels (in other words, there may be no net increase in "heads in beds" as a local economic driver). To assess the potential for regional or statewide tournament play, a more in-depth market study should be completed, and this is outside the scope of the current project.

Revenue Scenarios

Expanding upon the assumptions noted above and using the 2014 actual park revenues as a baseline, a series of revenue alternatives were generated. Three scenarios were calculated to include the following:

- High-growth option, which includes an 80% peak period utilization for shelters and barn, the installation of a water-based concessionaire, and increased usage of sport and event facilities.
- Moderate-growth option, which is primarily driven by a 50% peak period utilization for shelters and barn, along with modest increases in the usage of sport and event facilities.
- No-growth option, which maintains the utilization of facilities from the 2014 season, in addition to the third picnic shelter and community gardens.

Table 4 outlines the estimated revenues by scenario and park amenity. Percentage increases in revenue by line item are also noted for each scenario.

Table 4: Revenue Scenarios by Facility

Source	2014 (Actuals)	Revenue Potential					
		High Growth	% Incr	Moderate Growth	% Incr	No Growth	% Incr
River Shelter	\$ 8,871	\$ 26,113	194%	\$ 16,465	86%	\$ 11,225	27%
Forest Shelter	\$ 7,679	\$ 21,886	185%	\$ 13,800	80%	\$ 4,844	-37%
Splash Shelter	\$ 848	\$ 1,450	71%	\$ 1,080	27%	\$ 875	3%
Maintenance Barn Shelter	NA	\$ 26,113		\$ 16,465		\$ 11,225	
Stein-Boozier Barn	\$ 10,815	\$ 31,689	193%	\$ 19,601	81%	\$ 12,517	16%
Murase Plaza	\$ -						
Fields: Reduced Fee Youth	\$ 8,002	\$ 10,000	25%	\$ 9,000	12%	\$ 8,000	0%
Fields: Other	\$ 2,665	\$ 3,200	20%	\$ 3,000	13%	\$ 2,700	1%
Special Events	\$ 8,813	\$ 4,400	-50%	\$ 4,000	-55%	\$ 3,400	-61%
Community Gardens - raised bed	\$ 375	\$ 750	100%	\$ 750	100%	\$ 375	0%
Community Gardens - in-ground	\$ 2,178	\$ 2,640	21%	\$ 2,640	21%	\$ 2,178	0%
Watercraft Concessionaire	NA	\$ 4,500		\$ -		\$ -	
	\$ 50,244	\$ 132,740		\$ 86,801		\$ 57,339	

The primary intent of these scenarios is to illustrate the revenue potential for the park, given its wealth of reservable and rentable facilities. It must be noted that a number of factors may influence the City's potential to generate these revenues, and these factors include the City's capacity to promote availability and capture reservations, competition from other venues, seasonality, and the state of the overall local economy and people's willingness to spend.

As noted above, the shelters and the barn are expected to remain as the park's highest revenue generators. During the 2014 season, these facilities contributed over 56% of the total revenue from the park. As shown in Table 4, these facilities are assumed to generate approximately 80% of potential revenues, which is partly driven by the addition of the third shelter and by higher utilization rates. Regarding sport fields, the projected revenues are restrained by the assumption about local usage and the City's existing policy to offer discounted field fees for youth athletics.

Operating Expenses

The annual operations and maintenance of Memorial Park are a significant on-going expense, and the pace of future park improvements will be informed, in part, by the likely operations impacts to the City budget. Table 6 illustrates the current maintenance expenses for Memorial Park by major work area and shows an annual outlay of approximately \$286,000 for the park.

Table 5: Operations and Maintenance Expenses by Major Work Area/Feature (2014)

Park Feature	Unit	Labor Hours per Year per Unit	No. Units	Labor Hours per Year	Labor-related Cost per Year	Materials & Services per Yr	Total Cost per Year
Labor-related costs							
Large turf areas	per acre	52.0	15.0	780.0	\$ 19,500	\$ 3,000	\$ 22,500
Small/medium turf areas	per acre	52.0	3.0	156.0	\$ 3,900	\$ 600	\$ 4,500
Shrub beds	per 1000sf	52.0	12.0	624.0	\$ 15,600	\$ 500	\$ 16,100
Flower beds	per 1000sf	26.0	2.0	52.0	\$ 1,300	\$ 250	\$ 1,550
Planted trees	per tree	13.0	12.0	156.0	\$ 3,900	\$ 1,000	\$ 4,900
Hard surfaces	per 1000sf	3.0	200.0	600.0	\$ 15,000	\$ 250	\$ 15,250
Soft-surface paths/areas	per 1000sf	2.0	50.0	100.0	\$ 2,500	\$ 500	\$ 3,000
Turf multi-use fields	per field	52.0	3.0	156.0	\$ 3,900	\$ 3,000	\$ 6,900
Turf softball fields	per field	85.0	5.0	425.0	\$ 10,625	\$ 1,000	\$ 11,625
Irrigation system	per acre (irrigated)	10.0	28.0	280.0	\$ 7,000	\$ 8,000	\$ 15,000
Structures - clean/inspect/repair	per structure	35.0	5.0	175.0	\$ 4,375	\$ 250	\$ 4,625
Restrooms - clean & re-supply	per restroom	80.0	4.0	320.0	\$ 8,000	\$ 5,000	\$ 13,000
Play equipment - inspect & repair	per structure	48.0	2.0	96.0	\$ 2,400	\$ 1,000	\$ 3,400
Leaf removal	per acre (dev)	7.0	30.0	210.0	\$ 5,250	\$ 1,500	\$ 6,750
Storm debris	per acre (dev)	3.0	30.0	90.0	\$ 2,250	\$ 1,000	\$ 3,250
Security check & litter removal	per total acre	26.0	1.0	26.0	\$ 650	\$ 100	\$ 750
Empty trash cans	per can	30.0	30.0	900.0	\$ 22,500	\$ 1,000	\$ 23,500
Non-routine projects	per total acre	120.0	1.0	120.0	\$ 3,000	\$ 500	\$ 3,500
Contracted costs							
		Cost/Unit					
Water service	per acre (irrigated)	\$ 3,080	25.0		\$ 77,000		\$ 77,000
Solid waste service	per bin	\$ 1,800	1.0		\$ 1,800		\$ 1,800
Electricity service	per acre (dev)	\$ 1,400	25.0		\$ 35,000		\$ 35,000
Porta-potty service	per each	\$ 900	5.0		\$ 4,500		\$ 4,500
Contract repairs	per acre (dev)	\$ 250	1.0		\$ 250		\$ 250
Landscape maintenance service	per acre (dev)	\$ 500	1.0		\$ 500		\$ 500
Equipment rental	per acre (dev)	\$ 750	3.0		\$ 2,250		\$ 2,250
Equipment repair & maintenance	per acre (dev)	\$ 1,000	5.0		\$ 5,000		\$ 5,000
Totals				5266	\$ 131,700	\$ 154,800	\$ 286,400

The development of the preferred master plan will result in additional maintenance obligations for the City, and the following list itemizes the major quantity changes for park amenities.

- 35,000 sq.ft. new parking lot landscape
- 240,000 sq.ft. of disc golf
- 31,000 sq.ft. of pump track
- 2,400 sq.ft. skate spot
- 1 new picnic shelter with 5,400 sq.ft. lawn area
- 2 new restroom facilities
- 2 new tennis courts
- 2 new pickleball courts
- 270,500 sq.ft. synthetic turf (replaces natural turf)
- 650 lf of new terraced seating at amphitheater and fountain

- 4,000 sq.ft. additional community gardens
- 5,400 lf additional paved trails
- 12,000 sq.ft. additional concrete/asphalt hardscape
- 105,000 sq.ft. additional parking lot asphalt

Recognizing that the full master plan may not be implemented all at one time and that options exist for incremental enhancements to the park, the following operations cost estimate assumes full build-out of the park as shown in the master plan.

Table 6: Operations and Maintenance Expenses for Preferred Master Plan

Park Feature	Unit	Labor Hours per Year per Unit	No. Units	Labor Hours per Year	Labor-related Cost per Year	Materials & Services per Yr	Total Cost per Year
Labor-related costs							
Large turf areas	per acre	52.0	14.1	733.2	\$ 18,330	\$ 3,000	\$ 21,330
Small/medium turf areas	per acre	52.0	3.4	176.8	\$ 4,420	\$ 700	\$ 5,120
Shrub beds	per 1000sf	52.0	47.0	2444.0	\$ 61,100	\$ 1,500	\$ 62,600
Flower beds	per 1000sf	26.0	3.0	78.0	\$ 1,950	\$ 400	\$ 2,350
Planted trees	per tree	13.0	40.0	520.0	\$ 13,000	\$ 1,000	\$ 14,000
Hard surfaces	per 1000sf	3.0	382.7	1148.1	\$ 28,703	\$ 1,500	\$ 30,203
Soft-surface paths/areas	per 1000sf	2.0	50.0	100.0	\$ 2,500	\$ 500	\$ 3,000
Turf multi-use fields	per field	52.0	1.0	52.0	\$ 1,300	\$ 2,500	\$ 3,800
Turf softball fields	per field	85.0	3.0	255.0	\$ 6,375	\$ 800	\$ 7,175
Synthetic turf fields	per field	42.0	3.0	126.0	\$ 3,150	\$ 500	\$ 3,650
Irrigation system	per acre (irrigated)	10.0	22.0	220.0	\$ 5,500	\$ 8,000	\$ 13,500
Structures - clean/inspect/repair	per structure	35.0	7.0	245.0	\$ 6,125	\$ 400	\$ 6,525
Restrooms - clean & re-supply	per restroom	80.0	6.0	480.0	\$ 12,000	\$ 7,500	\$ 19,500
Play equipment - inspect & repair	per structure	48.0	4.0	192.0	\$ 4,800	\$ 2,000	\$ 6,800
Leaf removal	per acre (dev)	7.0	35.0	245.0	\$ 6,125	\$ 1,500	\$ 7,625
Storm debris	per acre (dev)	3.0	35.0	105.0	\$ 2,625	\$ 1,000	\$ 3,625
Security check & litter removal	per total acre	36.0	1.0	36.0	\$ 900	\$ 100	\$ 1,000
Empty trash cans	per can	30.0	36.0	1080.0	\$ 27,000	\$ 1,000	\$ 28,000
Non-routine projects	per total acre	200.0	1.0	200.0	\$ 5,000	\$ 500	\$ 5,500
Contracted costs							
		Cost/Unit					
Water service	per acre (irrigated)	\$ 3,080	22.0			\$ 67,760	\$ 67,760
Solid waste service	per bin	\$ 1,800	2.0			\$ 3,600	\$ 3,600
Electricity service	per acre (dev)	\$ 1,400	35.0			\$ 49,000	\$ 49,000
Porta-potty service	per each	\$ 900	5.0			\$ 4,500	\$ 4,500
Contract repairs	per acre (dev)	\$ 250	1.0			\$ 250	\$ 250
Landscape maintenance service	per acre (dev)	\$ 500	1.0			\$ 500	\$ 500
Equipment rental	per acre (dev)	\$ 750	6.0			\$ 4,500	\$ 4,500
Equipment repair & maintenance	per acre (dev)	\$ 1,000	8.0			\$ 8,000	\$ 8,000
Totals				8436	\$ 210,900	\$ 172,500	\$ 383,400

The annual operating costs for the preferred master plan are estimated to be approximately \$383,000 and approximately \$100,000 higher than the current maintenance costs. The largest impacts to the costs for the preferred master plan are due to increased quantities for hard surfaces

(parking, sport courts, trails), play equipment and landscape maintenance (shrubs and trees). With the installation of synthetic field turf, decreases in annual costs are anticipated for large turf areas, irrigation, and field sport maintenance.

As the City considers incremental or phased improvements to Memorial Park, the projected maintenance costs should be re-evaluated.

Additional Considerations

Other municipalities have sought and leveraged partnerships to either help offset maintenance costs or conditionally expand facilities. Such arrangements are best suited toward single-use or special purpose facilities. In advance of implementing the preferred master plan, the City should consider reaching out specifically to user groups for three facilities: off-leash area, pump track and disc golf.

- Advocates for off-leash areas in other cities have successfully organized into non-profit (501C3) entities to create a vehicle for fundraising for off-leash area maintenance and acting as a source of volunteers to clean-up days or special fundraising events.
- One option to help offset maintenance costs for the pump track is to develop a volunteer base of cyclists for seasonal work parties, clean-ups and (re)construction activities.
- Similarly, the City can seek the support of local disc golf enthusiasts and clubs for assistance in laying out, installing and maintaining the disc golf course.

These alternatives should be considered in addition to and in coordination with the City's ongoing maintenance standards, protocols and staffing - with the recognition that volunteer support for maintenance activities will not diminish the need for and role of park maintenance staff.

PAGE LEFT INTENTIONALLY BLANK

Memorial Park Master Plan Wilsonville, Oregon Walker Macy Portland, Oregon Master Plan Probable Cost Estimate 1.4	Architectural Cost Consultants, LLC Stanley J. Pszczolkowski, AIA 8060 SW Pfaffle Street, Suite 110 Tigard, Oregon 97223-8489 Phone: (503) 718-0075 Fax: (503) 718-0077 www.ArchCost.com	Estimate Date: 20-Jul-15 Document Date: 18-Feb-15 Print Date: 20-Jul-15 Print Time: 1:00 PM Constr. Start: Todays Cost
--	---	--

DIRECT CONSTRUCTION COST SUMMARY

Component	Area	\$ / SF	Total
Masterplan Estimate	5,494,582 sf	\$2.14 /sf	\$11,736,703
TOTAL DIRECT CONSTRUCTION COST	5,494,582 sf	\$2.14 /sf	\$11,736,703
Budget			0
Indicated Surplus / (Deficit)			(11,736,703)
<u>ALTERNATES</u> - None Indicated for Pricing			

The above estimates are for direct construction cost only. They do not include furnishings & equipment, architect and engineer design fees, consultant fees, inspection and testing fees, plan check fees, state sales tax, hazardous material testing and removal, financing costs, owners contingency, nor any other normally associated development costs.

The above estimates assume a competitively bid project, with at least three qualified bidders in each of the major sub-trades as well as the general contractors.

The above estimates assume a construction start date of: Todays Cost. If the start of construction is delayed beyond the date above, the estimates must be indexed at a rate of 5% to 7% per year compounded.

This is a probable cost estimate based on in-progress documentation provided by the architect. The actual bid documents will vary from this estimate due to document completion, detailing, specification, addendum, etc. The estimator has no control over the cost or availability of labor, equipment, materials, over market conditions or contractor's method of pricing, contractor's construction logistics and scheduling. This estimate is formulated on the estimator's professional judgment and experience. The estimate makes no warranty, expressed or implied, that the quantities, bids or the negotiated cost of the work will not vary from the estimator's opinion of probable construction cost.

Memorial Park Master Plan Wilsonville, Oregon Walker Macy Portland, Oregon Master Plan Probable Cost Estimate 1.4	Architectural Cost Consultants, LLC		Estimate Date: 20-Jul-15
	Stanley J. Psczolkowski, AIA		Document Date: 18-Feb-15
	8060 SW Pfaffle Street, Suite 110		Print Date: 20-Jul-15
	Tigard, Oregon 97223-8489		Print Time: 1:00 PM
	Phone: (503) 718-0075 Fax: (503) 718-0077 www.ArchCost.com		Constr. Start: Todays Cost

Masterplan Estimate	Quantity	Unit	Cost / Unit	Cost	Sub-totals	Comments
---------------------	----------	------	-------------	------	------------	----------

02 EXISTING CONDITIONS						
Site Demolition						
misc demo - allowance	1	sum	\$15,000.00	\$15,000		
removal of invasive species - allowance		acre	1,500.00	0		acreage TBD
remove trails	1	sum	500.00	500		
remove basketball court	1	sum	8,528.44	8,528		
remove skate park	1	sum	3,000.00	3,000		
remove restroom	1	sum	500.00	500		
remove ac paving	20,000	sf	0.55	11,000		
remove gravel parking areas	60,000	sf	0.50	30,000		
remove fencing at community garden	700	lf	3.50	2,450		
remove utilities	1	sum	5,000.00	5,000		
remove lighting	1	sum	35,000.00	35,000		
haul & disposal	1	sum	16,650.00	16,650		
Sub-total	5,494,582	sf	0.02 /sf		\$127,628	
SUB-TOTAL 02 EXISTING CONDITIONS			0.02 /sf		\$127,628	

31 EARTHWORK						
Clearing & Grubbing						
clear & grub	714,400	sf	0.05	35,720		
haul & disposal	1	sum	5,360.00	5,360		
Sub-total	5,494,582	sf	0.01 /sf		41,080	
Stripping & Stockpiling						
strip & stockpile, assume 4"	5,250	cy	6.00	31,500		
Sub-total	5,494,582	sf	0.01 /sf		31,500	
Grading / Site Excavation & Fill						
mobilization / demobilization	1	sum	30,000.00	30,000		
construction staking	1	sum	7,500.00	7,500		
cut (assume dry weather conditions)	6,100	cy	8.00	48,800		from forest shelter
cut (assume dry weather conditions)	7,524	cy	8.00	60,189		from ballfields # 1 & 2
fill (assume dry weather conditions)	326	cy	10.00	3,260		
haul excess material off-site	13,298	cy	12.00	159,571		
level / grade / proof roll	714,400	sf	0.30	214,320		
flagging / temp barricade / cleanup	1	sum	20,000.00	20,000		
Sub-total	5,494,582	sf	0.10 /sf		543,640	
Erosion & Sedimentation Controls						
allowance for work not shown	1	sum	75,000.00	75,000		
Sub-total	5,494,582	sf	0.01 /sf		75,000	
SUB-TOTAL 31 EARTHWORK			0.13 /sf		\$691,220	

Memorial Park Master Plan Wilsonville, Oregon Walker Macy Portland, Oregon Master Plan Probable Cost Estimate 1.4	Architectural Cost Consultants, LLC Stanley J. Psczolkowski, AIA 8060 SW Pfaffle Street, Suite 110 Tigard, Oregon 97223-8489 Phone: (503) 718-0075 Fax: (503) 718-0077 www.ArchCost.com		Estimate Date: 20-Jul-15 Document Date: 18-Feb-15 Print Date: 20-Jul-15 Print Time: 1:00 PM Constr. Start: Todays Cost

Masterplan Estimate	Quantity	Unit	Cost / Unit	Cost	Sub-totals	Comments
32 EXTERIOR IMPROVEMENTS						
Northeast Parking Lot						
4" ac pavement, drive aisles	116	ton	95.00	11,020		4,640 sf
6" base course	167	ton	20.00	3,335		
2" leveling course	56	ton	23.50	1,306		
2" ac pavement, parking stalls	82	ton	95.00	7,760		6,535 sf
4" base course	157	ton	20.00	3,131		
2" leveling course	78	ton	23.50	1,840		
geotextile fabric	1,242	sy	1.65	2,049		
concrete curb, vertical	600	lf	12.50	7,500		
4" base course	29	ton	20.00	575		
pavement markings						
ada logo	2	ea	85.00	170		
diagonal striping	90	sf	2.25	203		
parking stall striping	25	ea	18.00	450		
ada sign, post & footing	2	ea	200.00	400		
Sub-total	5,494,582	sf	0.01 /sf		39,739	\$3.56 /sf
East Parking Lot						
4" ac pavement, drive aisles	627	ton	95.00	59,527		25,064 sf
6" base course	901	ton	20.00	18,015		
2" leveling course	300	ton	23.50	7,056		
2" ac pavement, parking stalls	288	ton	95.00	27,313		23,000 sf
4" base course	551	ton	20.00	11,021		
2" leveling course	276	ton	23.50	6,475		
geotextile fabric	5,340	sy	1.65	8,812		
concrete curb, vertical	1,185	lf	12.50	14,813		
4" base course	57	ton	20.00	1,136		
pavement markings						
ada logo	4	ea	85.00	340		
diagonal striping	180	sf	2.25	405		
parking stall striping	105	ea	18.00	1,890		
ada sign, post & footing	4	ea	200.00	800		
bike racks	18	ea	325.00	5,850		
Sub-total	5,494,582	sf	0.03 /sf		163,453	\$3.40 /sf
Southwest Parking Lot						
4" ac pavement, drive aisles	603	ton	95.00	57,309		24,130 sf
6" base course	867	ton	20.00	17,343		
2" leveling course	289	ton	23.50	6,793		
2" ac pavement, parking stalls	271	ton	95.00	25,709		21,650 sf
4" base course	519	ton	20.00	10,374		
2" leveling course	259	ton	23.50	6,095		
geotextile fabric	5,087	sy	1.65	8,393		
concrete curb, vertical	620	lf	12.50	7,750		
4" base course	30	ton	20.00	594		
pavement markings						
ada logo	5	ea	85.00	425		
diagonal striping	270	sf	2.25	608		
parking stall striping	96	ea	18.00	1,728		
crosswalk striping	100	lf	5.50	550		
ada sign, post & footing	5	ea	200.00	1,000		
Sub-total	5,494,582	sf	0.03 /sf		144,671	\$3.16 /sf

Memorial Park Master Plan Wilsonville, Oregon Walker Macy Portland, Oregon Master Plan Probable Cost Estimate 1.4	Architectural Cost Consultants, LLC		Estimate Date: 20-Jul-15
	Stanley J. Psczolkowski, AIA		Document Date: 18-Feb-15
	8060 SW Pfaffle Street, Suite 110		Print Date: 20-Jul-15
	Tigard, Oregon 97223-8489		Print Time: 1:00 PM
	Phone: (503) 718-0075 Fax: (503) 718-0077 www.ArchCost.com		Constr. Start: Todays Cost

Masterplan Estimate	Quantity	Unit	Cost / Unit	Cost	Sub-totals	Comments
---------------------	----------	------	-------------	------	------------	----------

32 EXTERIOR IMPROVEMENTS - Continued						
Gravel Road	11,150	sf				
8" base course	534	ton	20.00	10,685		
2" leveling course	134	ton	23.50	3,139		
geotextile fabric	1,239	sy	1.65	2,044		
barrier arm gate at south prkg	1	ea	2,500.00	2,500		@ gravel road access
bollard type barriers	17	ea	250.00	4,250		allowance, verify
Sub-total	5,494,582	sf	0.00 /sf		22,618	\$2.03 /sf
Asphalt Trails						
2" ac pavement	1,767	ton	95.00	167,883		141,375 sf
4" base course	3,387	ton	20.00	67,742		
2" leveling course	1,694	ton	23.50	39,799		
geotextile fabric	15,708	sy	1.65	25,919		
stairs on grade, 8' wide	352	lf	45.00	15,840		allowance, verify type
railings	104	lf	65.00	6,760		
benches	9	ea	1,200.00	10,800		allowance, verify type
Sub-total	5,494,582	sf	0.06 /sf		334,743	\$2.37 /sf
Rock Trails	91,482	sf				
4" base course	2,192	ton	20.00	43,835		
2" leveling rock course	1,096	ton	28.25	30,959		
geotextile fabric	10,165	sy	1.65	16,772		
nature based playground areas	5	areas	5,000.00	25,000		allowance
benches	16	ea	1,200.00	19,200		allowance, verify type
boardwalk	2,224	sf	45.00	100,080		
lookout stone walls, assume 2' ht.	181	lf	150.00	27,150		
Sub-total	5,494,582	sf	0.05 /sf		262,996	\$2.87 /sf
Synthetic Turf Ballfields #1 & 2						
cement amended subgrade, 12" depth	30,094	sy	2.35	70,722		allowance, verify
synthetic turf: ball fields	270,850	sf	4.20	1,137,570		
shock pad underlayment	270,850	sf	1.00	270,850		
4" base course	6,489	ton	30.00	194,673		
2" leveling course	3,245	ton	35.00	113,560		
geotextile fabric	36,113	sy	1.65	59,587		
concrete curb at synthetic turf perimeter	2,440	lf	16.00	39,040		
2x nailer board	2,440	lf	7.80	19,032		
1.5"x12" ads flat drain pipe @ 20' oc	12,900	lf	15.00	193,500		
8" perf pipe, collector	1,375	lf	55.00	75,625		
10" perf pipe, collector	475	lf	60.00	28,500		
cleanouts, 8"	13	ea	600.00	7,800		
dugouts (4 each), 10'x30'	1,200	sf	79.00	94,800		
baseball backstops	2	ea	75,000.00	150,000		allowance, verify size/type
black vinyl chainlink fence, 6' ht.	200	lf	40.00	8,000		@ baseball base lines
baseball / softball diamond equipment	2	set	800.00	1,600		
bull pen equipment, pitcher+home plates		sets	250.00	0		NIC, verify
20' baseball foul pole with wing	4	ea	2,700.00	10,800		
portable outfield fencing, 6' ht. x 10'	1,100	lf	78.00	85,800		Sportafence or similar
soccer goals	4	ea	2,500.00	10,000		
Sub-total	5,494,582	sf	0.47 /sf		2,571,459	\$9.49 /sf

Memorial Park Master Plan Wilsonville, Oregon Walker Macy Portland, Oregon Master Plan Probable Cost Estimate 1.4	Architectural Cost Consultants, LLC		Estimate Date: 20-Jul-15
	Stanley J. Pszczolkowski, AIA		Document Date: 18-Feb-15
	8060 SW Pfaffle Street, Suite 110		Print Date: 20-Jul-15
	Tigard, Oregon 97223-8489		Print Time: 1:00 PM
	Phone: (503) 718-0075 Fax: (503) 718-0077 www.ArchCost.com		Constr. Start: Today's Cost

Masterplan Estimate	Quantity	Unit	Cost / Unit	Cost	Sub-totals	Comments
---------------------	----------	------	-------------	------	------------	----------

32 EXTERIOR IMPROVEMENTS - Continued						
Natural Turf Ballfields #3, 4 & 5						
renovate natural turf	215,000	sf	0.75	161,250		allowance
dugouts (4 each), 10'x30'	1,200	sf	79.00	94,800		
baseball backstops	2	ea	75,000.00	150,000		allowance, verify size/type
black vinyl chainlink fence, 6' ht.	200	lf	40.00	8,000		@ baseball base lines
baseball / softball diamond equipment	2	set	800.00	1,600		
bull pen equipment, pitcher+home plates		sets	250.00	0		NIC, verify
20' baseball foul pole with wing	4	ea	2,700.00	10,800		
portable outfield fencing, 6' ht. x 10'	1,100	lf	78.00	85,800		Sportafence or similar
soccer goals	2	ea	2,500.00	5,000		
Sub-total	5,494,582	sf	0.09 /sf	517,250		\$2.41 /sf
Pickleball Courts						
2" ac pavement, at bleachers	29	ton	95.00	2,791		2,350 sf
2" ac pavement, ball courts	54	ton	95.00	5,165		4,350 sf
4" base course	161	ton	20.00	3,210		
2" leveling course	80	ton	23.50	1,886		
geotextile fabric	483	sy	1.65	797		
1/2" court surfacing + striping	4,350	sf	5.00	21,748		
pickleball court nets	4	ea	750.00	3,000		
alum. bleachers, 5 rows	96	lf	320.00	30,720		
covered structure, 20' ht.	6,100	sf	77.46	472,500		allowance, verify construction
Sub-total	5,494,582	sf	0.10 /sf	541,817		
Tennis Courts						
complete construction - allowance	1	sum	250,000.00	250,000		
Sub-total	5,494,582	sf	0.05 /sf	250,000		
Basketball Court						
2" ac pavement, ball courts	142	ton	95.00	13,503		11,371 sf
4" base course	272	ton	20.00	5,449		
2" leveling course	136	ton	23.50	3,201		
geotextile fabric	1,263	sy	1.65	2,085		
1/2" court surfacing + striping	11,371	sf	5.00	56,856		
basketball backstops, pole mounted	4	ea	1,950.00	7,800		
Sub-total	5,494,582	sf	0.02 /sf	88,894		\$7.82 /sf
Sand Volleyball Courts 3,600 sf						
volleyball sand courts, (2 ea)	100	cy	80.00	8,000		
perimeter containment - allowance	360	lf	20.00	7,200		
volleyball court nets	2	ea	1,800.00	3,600		
Sub-total	5,494,582	sf	0.00 /sf	18,800		\$5.22 /sf
Dog Park 67,850 sf						
black vinyl chainlink fence, 6' ht.	1,211	lf	40.00	48,420		@ dog park
man gate, 42"-48"	3	ea	450.00	1,350		
relocate shelters	2	ea	1,500.00	3,000		
dog park signs	2	ea	250.00	500		
dog bag dispenser on post	2	ea	350.00	700		
deep well dog waste receptacle	1	ea	1,500.00	1,500		allowance, verify
Sub-total	5,494,582	sf	0.01 /sf	55,470		\$0.82 /sf
Skate Park						
complete construction - allowance	6,400	sf	30.00	192,000		
Sub-total	5,494,582	sf	0.03 /sf	192,000		

Memorial Park Master Plan Wilsonville, Oregon Walker Macy Portland, Oregon Master Plan Probable Cost Estimate 1.4	Architectural Cost Consultants, LLC		Estimate Date: 20-Jul-15
	Stanley J. Pszczolkowski, AIA		Document Date: 18-Feb-15
	8060 SW Pfaffle Street, Suite 110		Print Date: 20-Jul-15
	Tigard, Oregon 97223-8489		Print Time: 1:00 PM
	Phone: (503) 718-0075 Fax: (503) 718-0077 www.ArchCost.com		Constr. Start: Today's Cost

Masterplan Estimate	Quantity	Unit	Cost / Unit	Cost	Sub-totals	Comments
---------------------	----------	------	-------------	------	------------	----------

32 EXTERIOR IMPROVEMENTS - Continued						
Bike Park						
pump track construction- allowance	1	sum	150,000.00	150,000		per Walker Macy
Sub-total	5,494,582	sf	0.03 /sf		150,000	
Amphitheater						
fill from forest shelter	325	cy	12.00	3,900		
stone retaining walls	765	lf	125.00	95,625		assume 3' ht.
steps on grade	88	lf	45.00	3,949		
2' stone wall at stage back	340	sf	145.00	49,300		assume 4' ht.
stage platform area	990	sf	25.00	24,750		assume raised concrete
Sub-total	5,494,582	sf	0.03 /sf		177,524	
Maintenance Facility						
building, complete - allowance	1,500	sf	190.00	285,000		
Sub-total	5,494,582	sf	0.05 /sf		285,000	
Restroom Facilities						
CXT building, 2 stalls	520	sf	158.00	82,160		@ dog park area
CXT building, 2 stalls	520	sf	158.00	82,160		@ new east parking lot
CXT building, 2 stalls	520	sf	158.00	82,160		@ new south parking lot
CXT building, 4 stalls	1,400	sf	123.00	172,200		@ tennis courts
renovate building + add 2 stalls	2,088	sf	160.00	334,080		north of ballfield #1
Sub-total	5,494,582	sf	0.14 /sf		752,760	
Concession Area						
building, complete	600	sf	175.00	105,000		@ new south parking lot
Sub-total	5,494,582	sf	0.01 /sf		105,000	and ballfields
Community Garden 27,950 sf						
black vinyl chainlink fence, 8' ht.	690	lf	52.00	35,880		
double gate, 12'	1	pair	1,800.00	1,800		
man gate, 42"-48"	1	ea	450.00	450		
topsoil-18" at plots (imported)	1,452	cy	28.00	40,656		for .6 acres
crushed granite pathways	1,814	sf	0.50	907		
water spigots & piping	1	sum	3,000.00	3,000		
kiosk - allowance	1	sum	2,500.00	2,500		
Sub-total	5,494,582	sf	0.02 /sf		85,193	
Frisbee Golf Course						
course layout & development	1	sum	4,500.00	4,500		allowance
concrete pads, 4'x8'	27	ea	320.00	8,640		
disc catchers, (9 set)	1	set	7,150.00	7,150		
rules sign	1	ea	166.25	166		
tee signs	9	ea	166.25	1,496		
Sub-total	5,494,582	sf	0.00 /sf		21,952	
Playground Area (south of tennis courts)						
black vinyl chainlink fence, 4' ht.	270	lf	30.00	8,100		
man gate, 36"	1	ea	350.00	350		
Sub-total	5,494,582	sf	0.00 /sf		8,450	
Miscellaneous Site Furnishings						
allowance for other site signage	1	sum	10,000.00	10,000		
allowance for trash receptacles	30	ea	1,000.00	30,000		allowance
Sub-total	5,494,582	sf	0.01 /sf		40,000	

Memorial Park Master Plan Wilsonville, Oregon Walker Macy Portland, Oregon Master Plan Probable Cost Estimate 1.4	Architectural Cost Consultants, LLC Stanley J. Psczolkowski, AIA 8060 SW Pfaffle Street, Suite 110 Tigard, Oregon 97223-8489 Phone: (503) 718-0075 Fax: (503) 718-0077 www.ArchCost.com		Estimate Date: 20-Jul-15 Document Date: 18-Feb-15 Print Date: 20-Jul-15 Print Time: 1:00 PM Constr. Start: Todays Cost

Masterplan Estimate	Quantity	Unit	Cost / Unit	Cost	Sub-totals	Comments
32 EXTERIOR IMPROVEMENTS - Continued						
Dock Launch						
Versi launch, Gatordock	3	slips	14,000.00	42,000		@ existing dock system
Sub-total	5,494,582	sf	0.01 /sf		42,000	
Landscape Irrigation						
new planting beds	36,200	sf	1.25	45,250		@ parking lots
new lawn areas only	35,000	sf	0.75	26,250		
pumps, controllers, etc - allowance	1	sum	15,000.00	15,000		
Sub-total	5,494,582	sf	0.02 /sf		86,500	
Planting						
trees, 1.5" cal.	455	ea	250.00	113,750		
repair lawn area	90,000	sf	0.50	45,000		allowance
new lawn area, seeding	35,000	sf	1.25	43,750		
new planting beds, minimal	36,200	sf	2.75	99,550		@ parking lots
establishment maintenance	1	sum	5,000.00	5,000		
Sub-total	5,494,582	sf	0.06 /sf		307,050	
SUB-TOTAL 32 EXTERIOR IMPROVEMENTS			1.32 /sf		\$7,265,339	

33 UTILITIES						
Water Utilities						
allowance for piping to new restrooms	1	sum	35,000.00	35,000		
Sub-total	5,494,582	sf	0.01 /sf		35,000	
Sanitary Sewerage Utilities						
allowance for piping to new restrooms	1	sum	28,500.00	28,500		
Sub-total	5,494,582	sf	0.01 /sf		28,500	
Storm Drainage Utilities						
site drainage systems						
see athletic surfacing above		sum	0.00	0		for sub-base drainage
allowance for site & parking lot	1	sum	50,000.00	50,000		
Sub-total	5,494,582	sf	0.01 /sf		50,000	

Memorial Park Master Plan Wilsonville, Oregon Walker Macy Portland, Oregon Master Plan Probable Cost Estimate 1.4	Architectural Cost Consultants, LLC		Estimate Date: 20-Jul-15
	Stanley J. Pszczolkowski, AIA		Document Date: 18-Feb-15
	8060 SW Pfaffle Street, Suite 110		Print Date: 20-Jul-15
	Tigard, Oregon 97223-8489		Print Time: 1:00 PM
	Phone: (503) 718-0075 Fax: (503) 718-0077 www.ArchCost.com		Constr. Start: Todays Cost

Masterplan Estimate	Quantity	Unit	Cost / Unit	Cost	Sub-totals	Comments
33 UTILITIES - Continued						
Electrical Utilities						
service/controls/distribution	1	sum	50,000.00	50,000		
site lighting						
ballfields #1,2,3 & 4	15	ea	48,000.00	720,000		
existing walkway, 12' poles @ 40'oc	12	ea	5,000.00	60,000		exist. prkg lot to ballfields
pickleball, at structure	1	sum	24,000.00	24,000		
parking lots	10	ea	15,000.00	150,000		
main walkway, 12' poles @ 40'oc	32	ea	5,000.00	160,000		between south & east prkg lots
Sub-total	5,494,582	sf	0.21 /sf		1,164,000	
SUB-TOTAL 33 UTILITIES			0.23 /sf		\$1,277,500	
SUB-TOTAL			1.70	9,326,687	\$9,361,687	
Estimating Contingency			10.00%	936,169		
Index To Construction Start	Today's Cost		0.00%	0		@ ± 6% per year
General Conditions / Insurance / Bond			10.00%	1,029,785		
General Contractor OH & Profit			4.00%	453,106	2,419,056	25.84%
TOTAL DIRECT CONSTRUCTION COST						
Masterplan Estimate	5,494,582	sf	\$2.14 /sf		\$11,780,743	126.14 acres

PAGE LEFT INTENTIONALLY BLANK

